

SUBJECT: A RESOLUTION OF THE MATANUSKA-SUSITNA BOROUGH ASSEMBLY AUTHORIZING THE BOROUGH MANAGER TO ENTER INTO AN AGREEMENT WITH MAT VALLEY MILLING FOR THE ALSOP A AND B SALVAGE TIMBER SALE (MSB006569AB).

AGENDA OF: February 21, 2023

ASSEMBLY ACTION: *Approved under the consent agenda.*
02/21/23.
(SP)

MANAGER RECOMMENDATION: Present to the Assembly for consideration.

APPROVED BY MICHAEL BROWN, BOROUGH MANAGER: *WBS*

Route To:	Department/Individual	Initials	Remarks
1	Originator	<i>EK</i>	
2	Community Development Director	<i>EP</i>	
3	Finance Director	<i>[Signature]</i>	
4	Borough Attorney	<i>[Signature]</i>	
5	Borough Clerk	<i>[Signature]</i>	<i>SP</i>

ATTACHMENT(S): Fiscal Note: YES X NO
Alsop A and B Timber Sale Map (1 pp)
Resolution Serial No. 23-013 (2 pp)

SUMMARY STATEMENT:

The Matanuska-Susitna Borough has received an offer for the purchase of an over-the-counter salvage timber sale as illustrated in the enclosed Alsop A and B Timber Sale Map. Alsop A and B Timber Sales were offered by competitive sealed bid after complying with the required 30-day public notice. No bids were received. Subsequently, the timber sale was offered over-the-counter, in accordance with MSB 23.20.130(A). Mat Valley Milling submitted an acceptable bid on the commercial timber sale. That timber sale contract was mutually terminated after recent weather events laid down most of the beetle killed and damaged spruce. The volume in the commercial timber contract was no longer accurate. It was determined that the reduced volume and poor quality of the timber is more suited for a salvage timber contract.

A salvage timber contract was offered over-the-counter with the recoverable volume of timber reduced based on updated inventory data from 2022.

The salvage timber sale contract will allow Mat Valley Milling to harvest and remove the merchantable spruce timber damaged or killed by the bark beetle as well as all birch greater than eight inches diameter at breast height by December 31, 2026. The land in which timber harvesting will occur has been classified Resource Management and Watershed. The salvage timber sale was offered to reduce fire danger in the neighborhood and improve forest health.

Access to the harvest area will need to be developed by the Purchaser. Alsop Road is adjacent to the northern boundary of the harvest area.

RECOMMENDATION:

Staff respectfully recommend Assembly adoption of the Resolution authorizing the Borough Manager to enter into an agreement with Mat Valley Milling for the Alsop A and B Salvage Timber Sale (MSB006569AB).

MATANUSKA-SUSITNA BOROUGH
FISCAL NOTE

Agenda Date: February 21, 2023

SUBJECT: A RESOLUTION OF THE MATANUSKA-SUSITNA BOROUGH ASSEMBLY AUTHORIZING THE BOROUGH MANAGER TO ENTER INTO AN AGREEMENT WITH MAT VALLEY MILLING FOR THE ALSOP A AND B TIMBER SALVAGE SALE (MSB006569AB).

ORIGINATOR: Community Development

FISCAL ACTION (TO BE COMPLETED BY FINANCE)	FISCAL IMPACT <u>YES</u> NO
AMOUNT REQUESTED <u>\$9,720⁰⁰</u>	FUNDING SOURCE
FROM ACCOUNT #	PROJECT #
TO ACCOUNT : <u>203.00.00 311.111</u>	PROJECT #
VERIFIED BY: <u>Kind Michael</u>	CERTIFIED BY:
DATE: <u>2-3-23</u>	DATE:

EXPENDITURES/REVENUES:

(Thousands of Dollars)

OPERATING	FY2023	FY2024	FY2025	FY2026	FY2027	FY20287
Personnel Services						
Travel						
Contractual						
Supplies						
Equipment						
Land/Structures						
Grants, Claims						
Miscellaneous						
TOTAL OPERATING						

CAPITAL						
---------	--	--	--	--	--	--

REVENUE	<u>9.7</u>					
---------	------------	--	--	--	--	--

FUNDING:

(Thousands of Dollars)

General Fund						
State/Federal Funds						
Other	<u>9.7</u>					
TOTAL	<u>9.7</u>					

POSITIONS:

Full-Time						
Part-Time						
Temporary						

ANALYSIS: (Attach a separate page if necessary)

PREPARED BY: _____ PHONE: _____
 DEPARTMENT: Chapman Dennis DATE: 2/3/23
 APPROVED BY: _____ DATE: _____

ALSOP A & B SALVAGE TIMBER SALE

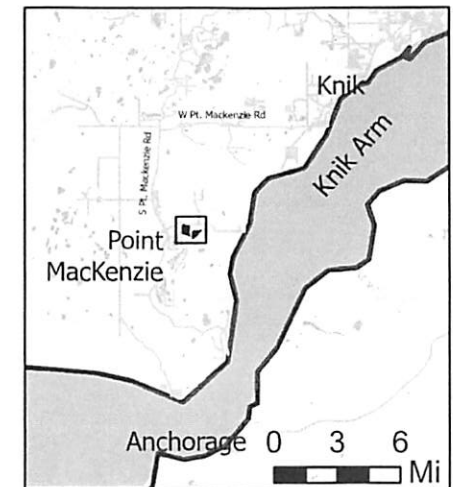
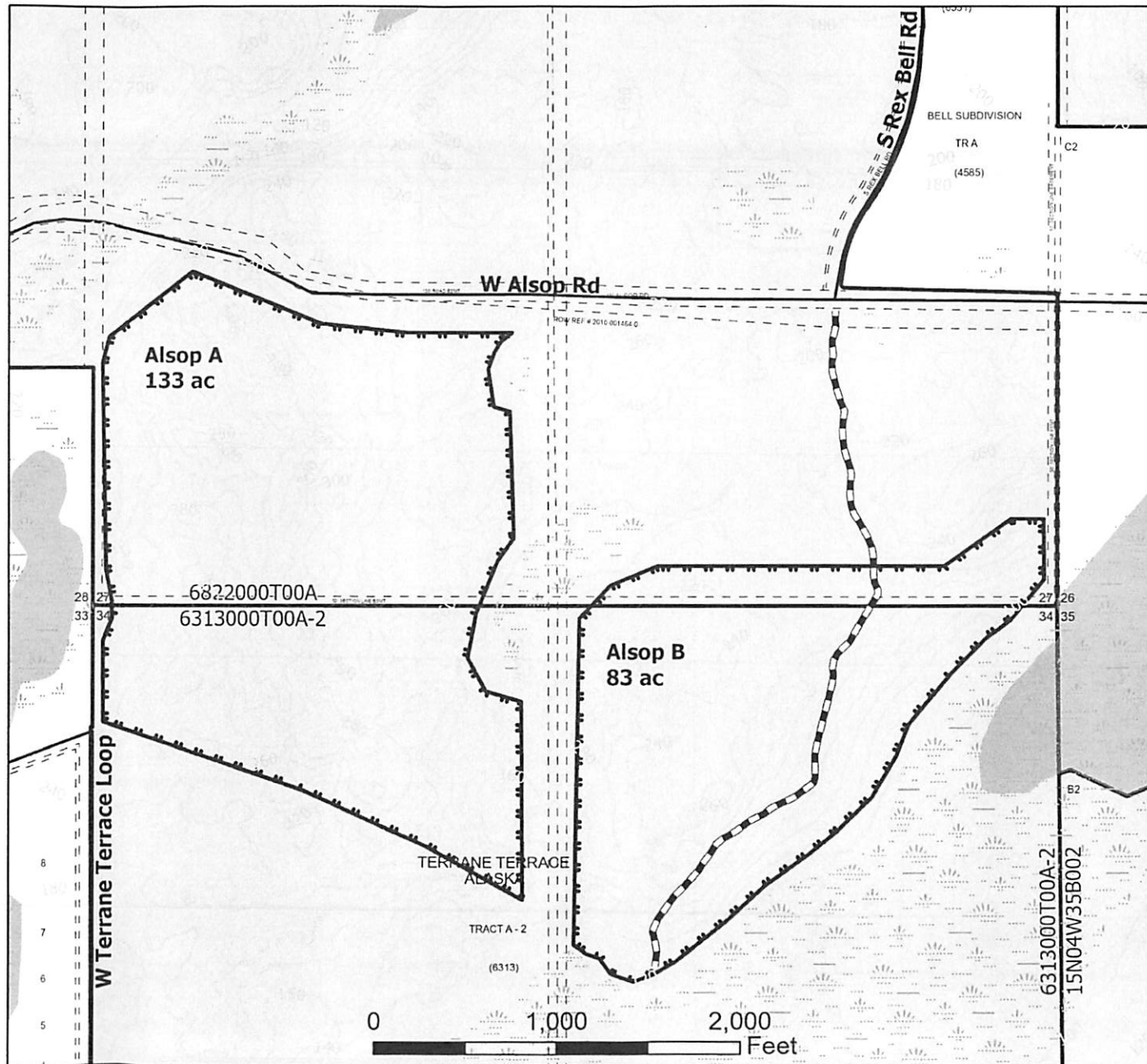

T15N R04W Sec. 27 & 34

MSB Parcel Tax ID
6313000T00A-2
6822000T00A



- Sale Boundary
- Mat-Su Borough
- Environment_Wetlands_NWI
- Environment_Waterbodies_MSB
- Skid_Trails
- Easements ROW

**MATANUSKA - SUSITNA BOROUGH
LAND & RESOURCE MANAGEMENT
DIVISION**



IM 23-036
RS 23-013