

**SUBJECT:** Award of Bid No. 21-006B, Supply and Install Furniture, Fixtures and Equipment (FFE) at Station 6-1 to multiple contractors for the contract amount of \$238,824.12.

**AGENDA OF:** August 18, 2020

**ASSEMBLY ACTION:**

*Approved under the consent  
Agenda 8-18-20*

**MANAGER RECOMMENDATION:** Present to the Assembly for consideration.

**APPROVED BY GEORGE HAYS, ACTING BOROUGH MANAGER:**

| Route To: | Department/Individual     | Initials          | Remarks         |
|-----------|---------------------------|-------------------|-----------------|
|           | Purchasing Officer        | <i>DLA</i>        | <i>8/5/2020</i> |
|           | Capital Projects Director | <i>CPD</i>        | <i>8/5/2020</i> |
|           | Finance Director          | <i>CF</i>         |                 |
|           | Borough Attorney          | <i>NS</i>         |                 |
|           | Borough Clerk             | <i>mm 8/11/20</i> | <i>(BOM)</i>    |

**ATTACHMENT (S):** Fiscal Note: Yes X No \_\_\_\_\_  
 Analysis Sheet: (2pp)  
 FFE Specifications: (36pp)

**SUMMARY STATEMENT:** On July 1, 2020 the Matanuska-Susitna Borough Purchasing Division issued a solicitation requesting bids from qualified contractors to provide all supervision, labor, tools and equipment necessary to supply and install FFE as part of the Matanuska-Susitna Borough's Public Safety Station 6-1 renovation and addition project. Goods purchased will support the Department of Emergency Services in Assembly District #4.

In response to the advertisement, five (5) bids were received. Award recommendation is being made to lowest responsive and responsible bidder for Bid Schedules A and B, (Capital Office, \$163,497.12), and Bid Schedule E, (Collins Construction, Inc., \$75,327.00). Bid Schedules C and D will not be awarded due to lack of funding.

Final completion of this project is March 31, 2021. In accordance with MSB 3.08.170(B), Administration requests authority to modify the resulting contract completion date by 30 days for unforeseen circumstances.

The Capital Projects Department, Project Management Division will be administering the contracts.

**RECOMMENDATION OF ADMINISTRATION:** Award of BID NO. 21-006B, SUPPLY AND INSTALL FURNITURE, FIXTURES AND EQUIPMENT AT STATION 6-1 to CAPITAL OFFICE and COLLINS CONSTRUCTION, INC. for the contract amount of TWO HUNDRED THIRTY EIGHT THOUSAND EIGHT HUNDRED TWENTY FOUR AND 12/100 DOLLARS (\$238,824.12).

MATANUSKA-SUSITNA BOROUGH  
FISCAL NOTE

Agenda Date: August 18, 2020

SUBJECT: Award of Bid No. 21-006B, Supply and Install Furniture, Fixtures and Equipment (FFE) at Station 6-1 to multiple contractors for the contract amount of \$238,824.12.

. ORIGINATOR: Purchasing

|  |  |
|--|--|
| FISCAL ACTION (TO BE COMPLETED BY FINANCE) | FISCAL IMPACT <span style="border: 1px solid black; border-radius: 50%; padding: 2px;">YES</span> NO |
| AMOUNT REQUESTED <u>\$238,824.12</u>       | FUNDING SOURCE <u>Fire Svc. Capital Projects Fund</u>  |
| FROM ACCOUNT # <u>405.000.000 4xx.xxx</u>  | PROJECT # <u>45066-6600-66662</u>  |
| TO ACCOUNT :                               | PROJECT #  |
| VERIFIED BY: <u>Cheryl Wierla</u>          | CERTIFIED BY:  |
| DATE: <u>8-6-2020</u>                      | DATE:  |

EXPENDITURES/REVENUES:

(Thousands of Dollars)

| OPERATING          | FY2021 | FY2022 | FY2023 | FY2024 | FY2025 | FY2026 |
|--------------------|--------|--------|--------|--------|--------|--------|
| Personnel Services |        |        |        |        |        |        |
| Travel             |        |        |        |        |        |        |
| Contractual        |        |        |        |        |        |        |
| Supplies           |        |        |        |        |        |        |
| Equipment          |        |        |        |        |        |        |
| Land/Structures    |        |        |        |        |        |        |
| Grants, Claims     |        |        |        |        |        |        |
| Miscellaneous      |        |        |        |        |        |        |
| TOTAL OPERATING    |        |        |        |        |        |        |

|         |              |  |  |  |  |  |
|---------|--------------|--|--|--|--|--|
| CAPITAL | <u>238.8</u> |  |  |  |  |  |
|---------|--------------|--|--|--|--|--|

|         |  |  |  |  |  |  |
|---------|--|--|--|--|--|--|
| REVENUE |  |  |  |  |  |  |
|---------|--|--|--|--|--|--|

FUNDING:

(Thousands of Dollars)

|                     |              |  |  |  |  |  |
|---------------------|--------------|--|--|--|--|--|
| General Fund        |              |  |  |  |  |  |
| State/Federal Funds |              |  |  |  |  |  |
| Other               | <u>238.8</u> |  |  |  |  |  |
| TOTAL               | <u>238.8</u> |  |  |  |  |  |

POSITIONS:

|           |  |  |  |  |  |  |
|-----------|--|--|--|--|--|--|
| Full-Time |  |  |  |  |  |  |
| Part-Time |  |  |  |  |  |  |
| Temporary |  |  |  |  |  |  |

ANALYSIS: (Attach a separate page if necessary)

PREPARED BY:

PHONE:

DEPARTMENT:

DATE:

APPROVED BY:

DATE:

Cheryl Wierla

8/14/2020



MATANUSKA-SUSITNA BOROUGH  
 BID #21-006B  
 Supply & Install FFE at Station 6-1  
 ANALYSIS SHEET

Page 1 of 2

| BIDDER  | Arctic Office   | Capital Office  | Think Office    |
|---|-----------------|-----------------|-----------------|
| Signed Bid Form   | ✓               | ✓               | ✓               |
| Acknowledgement of Addendum (3)   | ✓               | ✓ #3            | ✓               |
| Descriptive Literature  | ✓               | ✓               | ✓               |
| DESCRIPTION   | TOTAL BID PRICE | TOTAL BID PRICE | TOTAL BID PRICE |
| <b>Schedule A</b><br>Procure, supply and install all furnishings described and shown in the furniture specifications and cut sheets.                | \$ 155,916.00   | \$ 151,991.24   | \$ 176,314.98   |
| <b>Schedule B</b><br>Procure, supply and install manual roller blinds described in specification 12 24 10 and shown on the floor plan drawings.     | No Bid          | \$ 11,505.88    | No Bid          |
| <b>Schedule C</b><br>Procure, supply and install Extractor described in specification 10 00 00. Location is shown on the floor plan drawings.       | No Bid          | No Bid          | No Bid          |
| <b>Schedule D</b><br>Procure, supply and deliver Wire Mesh Lockers described in specification 10 51 40.   | No Bid          | \$ 36,813.43    | No Bid          |
| <b>Schedule E</b><br>Procure, supply and install Residential Appliances described in specification 11 30 13. Locations are shown on the floor plan. | No Bid          | No Bid          | No Bid          |

RECOMMENDATION: ALL BIDS ARE TAKEN UNDER ADVISEMENT ~PRELIMINARY RESULTS~

*[Signature]*  
 PURCHASING OFFICER

ASST PURCHASING OFFICER

7-24-2020  
 DATE

BUYER

CONST PROCUREMENT SPECIALIST

WITNESS

WITNESS

WITNESS

AM 20-087



MATANUSKA-SUSITNA BOROUGH  
BID #21-006B  
Supply & Install FFE at Station 6-1  
ANALYSIS SHEET

| BIDDER  | Binw Ak         | Collins Const   |
|---|-----------------|-----------------|
| Signed Bid Form   | ✓               | ✓               |
| Acknowledgement of Addendum (3)   | ✓               | ✓               |
| Descriptive Literature  | ✓               |                 |
| DESCRIPTION   | TOTAL BID PRICE | TOTAL BID PRICE |
| <b>Schedule A</b><br>Procure, supply and install all furnishings described and shown in the furniture specifications and cut sheets.                | \$ 201,309.77   | No Bid          |
| <b>Schedule B</b><br>Procure, supply and install manual roller blinds described in specification 12 24 10 and shown on the floor plan drawings.     | No Bid          | \$ 18,574.00    |
| <b>Schedule C</b><br>Procure, supply and install Extractor described in specification 10 00 00. Location is shown on the floor plan drawings.       | No Bid          | \$ 38,417.00    |
| <b>Schedule D</b><br>Procure, supply and deliver Wire Mesh Lockers described in specification 10 51 40.   | No Bid          | \$ 51,435.00    |
| <b>Schedule E</b><br>Procure, supply and install Residential Appliances described in specification 11 30 13. Locations are shown on the floor plan. | No Bid          | \$ 75,327.00    |

RECOMMENDATION: ALL BIDS ARE TAKEN UNDER ADVISEMENT ~PRELIMINARY RESULTS~

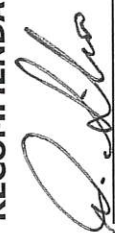
  
PURCHASING OFFICER

ASST PURCHASING OFFICER

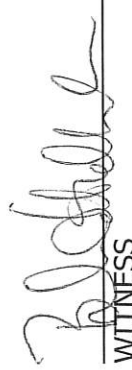
  
WITNESS

BUYER

CONST PROCUREMENT SPECIALIST

7-24-2020  
DATE

WITNESS

WITNESS

Am 20-087

Schedule "A"

Furniture Specifications

AM 20-087

## FURNITURE SPECIFICATION SHEET

MSB Station 6-1 Renovation and Addition  
Wasilla, Alaska

### INDEX

|        |                                      |
|--------|--------------------------------------|
| F5     | Wardrobe Cabinet                     |
| F4-1   | Bed Frame                            |
| F12    | Bedside Table                        |
| F4-3   | Mattress                             |
| F13    | TV Console                           |
| F8     | Recliner                             |
| F6     | Side Table                           |
| F15    | Dining Stool                         |
| F10    | Large Dining Table                   |
| F14-1  | Dining Chair 1                       |
| F9     | Small Dining Table                   |
| F14-2  | Dining Chair 2                       |
| F20-1  | Workstation 1                        |
| F29    | File Cabinet BBF (Workstation 1)     |
| F30    | File Cabinet Lateral (Workstation 1) |
| F23    | Bookcase                             |
| F11-1  | Meeting Table 1                      |
| F20-2  | Workstation 2                        |
| F20-3L | Workstation 3L (Left-Hand Return)    |
| F20-3R | Workstation 3R (Right-Hand Return)   |
| F16    | Task Chair 1                         |
| F17    | Task Chair 2                         |
| F18    | Side Chair                           |
| F11-2  | Meeting Table 2                      |
| F19    | Bench                                |
| F27    | Adjustable Height Foot Rest          |
| F22-1  | Lateral Files                        |
| F22-2  | Lateral Files with Storage Cabinet   |
| F25    | Mobile Pedestal File Cabinet BBF     |
| F26    | Mobile Pedestal File Cabinet FF      |
| F28    | Under-Counter Adjustable CPU Holder  |
| F31    | Metal Bench                          |



## FURNITURE SPECIFICATION SHEET

MSB Station 6-1 Renovation and Addition  
Wasilla, Alaska

### CREW SLEEPING ROOMS

Item Name: Wardrobe Cabinet  
Floor Plan Code: F5  
Manufacturer: RT London  
Product Name: Essentials, Wardrobe  
Model Number:  
Dimensions: 24"W x 24"D x 72"H  
Description: Plywood construction; hinged door with keyed lock; two interior drawers; hanger rod with shelf above; steel leg base

Finishes: Silver Steel Leg Base  
Wood Veneer Natural Maple Cabinet  
Bar Pull

Quantity: 65



### CREW SLEEPING ROOMS

Item Name: Bed Frame  
Floor Plan Code: F4-1  
Manufacturer: RT London  
Product Name: Maxwell Dorm Twin XL Bed  
Model Number:  
Dimensions: 85"L x 37"W x 39"H  
Description: Twin XL frame with steel legs and wood headboard; 14" under bed clearance; spring mattress deck

Finishes: Silver Steel Posts  
Natural Maple A4 Headboard  
Black Steel Spring Deck

Quantity: 17



## FURNITURE SPECIFICATION SHEET

MSB Station 6-1 Renovation and Addition  
Wasilla, Alaska

### CREW SLEEPING ROOMS

Item Name: Bedside Table  
Floor Plan Code: F12  
Manufacturer: RT London  
Product Name: Essentials, Nightstand 1-Drawer  
Model Number:  
Dimensions: 20"W x 18"D x 24"H  
Description:

Finishes: Natural Maple A4  
Bar Pull

Quantity: 16



### CREW SLEEPING ROOMS

Item Name: Mattress  
Floor Plan Code: F4-3  
Manufacturer: RT London  
Product Name: Blue Nylon, Dorm Twin XL  
Model Number:  
Dimensions: 80"L x 36"W x 8"H  
Description: Twin XL bed mattress; bacteria/ fungus resistant; fire-resistant fiber backing

Finishes: Nylon

Quantity: 17



## FURNITURE SPECIFICATION SHEET

MSB Station 6-1 Renovation and Addition  
Wasilla, Alaska

### DAY ROOM

Item Name: TV Console  
Floor Plan Code: F13  
Manufacturer: Knoll  
Product Name: Reff Profiles  
Model Number:  
Dimensions: 48"W x 20"D x 20"H  
Description: Veneer plywood construction; metal legs; aluminum bar pulls; two doors; adjustable shelf

Finishes: Plastic Laminate

Quantity: 1

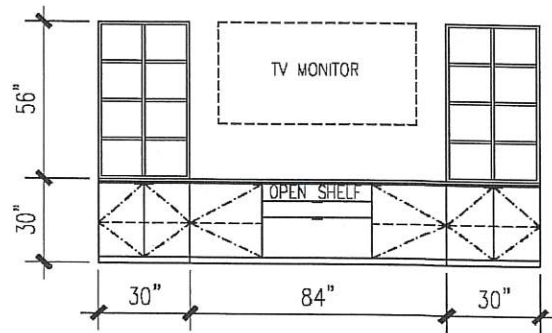

Base: 20"D x 28-3/8"H cabinets, drawers, and open shelf.

Counter: 20"D x 144"L plastic laminate.

Upper: 15"D x 30"W x 56"H open cabinets with adjustable shelves.

All plastic laminate Knoll Reff Profiles furnishings carry a Lifetime Manufacturer's Warranty.

### DAY ROOM

Item Name: Recliner  
Floor Plan Code: F8  
Manufacturer: American Firehouse Furniture  
Product Name: Fire Tough Recliner, Space Saver  
Model Number:  
Dimensions: 38"W x 45"D x 45"H  
Description: 300 lbs. rated weight capacity; heavy gauge steel springs and frame construction; hardwood seatbox construction; reinforced arm frames; bonded leather upholstery

Finishes: Black

Quantity: 12



Requires 6" clearance to back wall.  
Depth extends to 72" in fully reclined position.



## FURNITURE SPECIFICATION SHEET

MSB Station 6-1 Renovation and Addition  
Wasilla, Alaska

### DAY ROOM

Item Name: Side Table  
Floor Plan Code: F6  
Manufacturer: KI  
Product Name: C-Table  
Model Number:  
Dimensions: 18" dia. X 27"H  
Description: High pressure top; 2mm  
polypropylene edge banding; welded  
steel base

Finishes: Plastic laminate top  
Powder-coated steel leg

Quantity: 6



### KITCHEN

Item Name: Dining Stools  
Floor Plan Code: F15  
Manufacturer: KI  
Product Name: 600 Series Industrial Stool  
Model Number:  
Dimensions:  
Description: Height adjustable range from 19" to  
27"; solid wood seat, powder-coated  
steel legs with foot ring

Finishes: Wood Seat  
Black Steel Frame

Quantity: 5

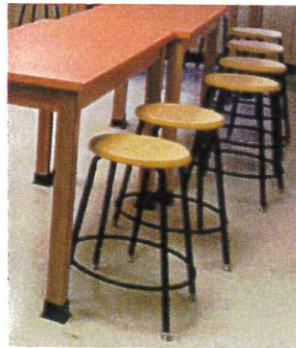

## FURNITURE SPECIFICATION SHEET

MSB Station 6-1 Renovation and Addition  
Wasilla, Alaska

### DINING AREA

Item Name: Large Dining Table  
Floor Plan Code: F10  
Manufacturer: Knoll Muuto  
Product Name: Base Table  
Model Number:  
Dimensions: 98.5"L x 35.5"W x 29"H  
Description: Table base of painted extruded aluminum; top is oak with lacquered veneer finish.

Finishes: Lacquered oak veneer top  
Painted extruded aluminum base

Quantity: 2



### DINING AREA

Item Name: Dining Chairs 1  
Floor Plan Code: F14-1  
Manufacturer: Knoll Muuto  
Product Name: Cover Side Chair  
Model Number:  
Dimensions: 21.1"W x 19.3"D x 29.7"H x 17.9"SH  
Description:

Finishes:

Quantity: 16

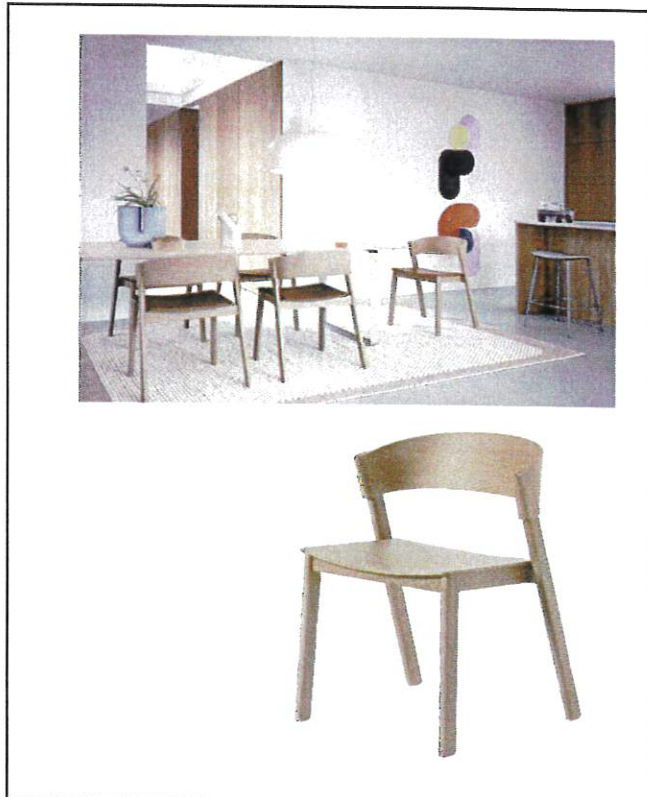

## FURNITURE SPECIFICATION SHEET

MSB Station 6-1 Renovation and Addition  
Wasilla, Alaska

### DAY ROOM ANNEX and ADMIN AREA BREAK ROOM

Item Name: Small Dining Table  
Floor Plan Code: F9  
Manufacturer: Knoll  
Product Name: Islands Collection  
Model Number:  
Dimensions: 30"W x 30"D x 29"H  
Description: Square X-Base Table

Finishes: Plastic laminate top  
Textured paint legs

Quantity: 4



### DAY ROOM ANNEX and ADMIN AREA BREAK ROOM

Item Name: Dining Chairs 2  
Floor Plan Code: F14-2  
Manufacturer: Knoll Muuto  
Product Name: Loft Chair  
Model Number:  
Dimensions: 16.7"W x 19"D x 31"H x 18"SH  
Description:

Finishes: Natural Finish on Oak - Shell  
Black Powder Coated Steel - Frame

Quantity: 16

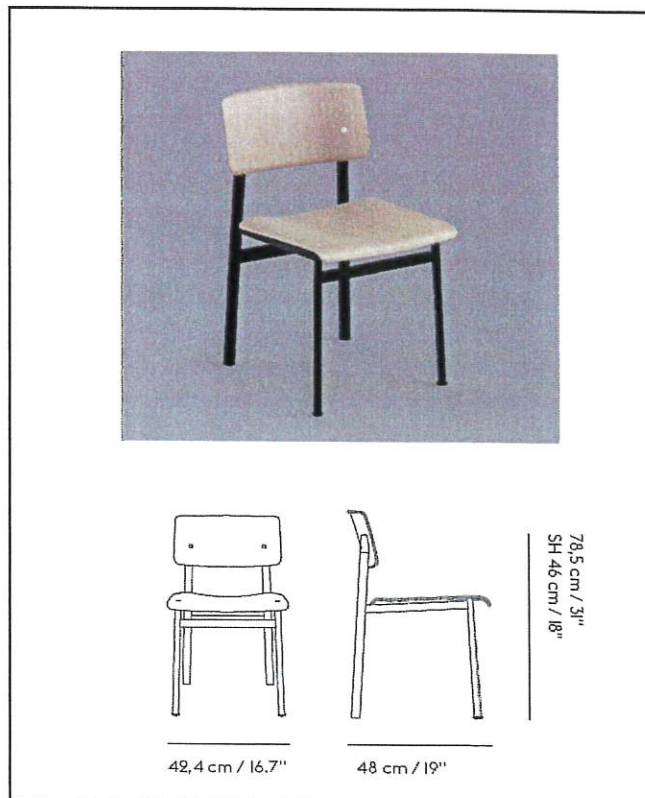



FURNITURE SPECIFICATION SHEET

MSB Station 6-1 Renovation and Addition  
Wasilla, Alaska

CHIEF OFFICE

Item Name: Work Station Type 1  
Floor Plan Code: F20-1  
Manufacturer: Knoll  
Product Name: Reff Profiles  
Model Number:  
Dimensions: See Plan Below  
Description: U-Shaped 7'-0"W x 8'-8"D workstation;  
30" x 84" electric height adjustable  
work surface with full height modesty  
panel; wall mounted overhead storage  
cabinets with open cubbies and shelf;  
tackboard between overhead storage  
cabinets and work surface  
  
Finishes: Plastic laminate work surfaces,  
cabinets, door and drawer fronts  
Powder coated steel supports

Quantity: 1



Overhead storage on back wall - see elevation.

All plastic laminate Knoll Reff Profiles furnishings carry a  
Lifetime Manufacturer's Warranty.

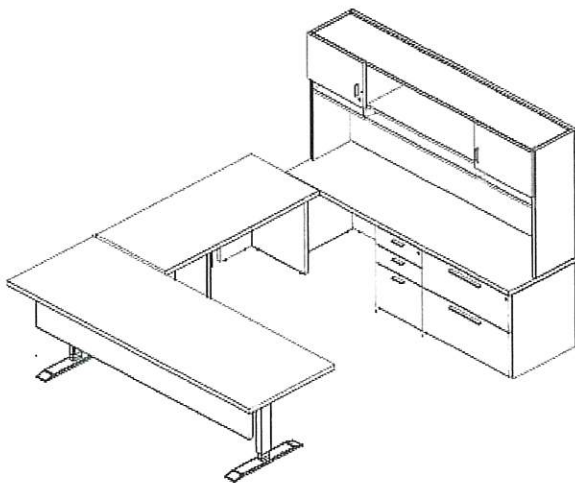
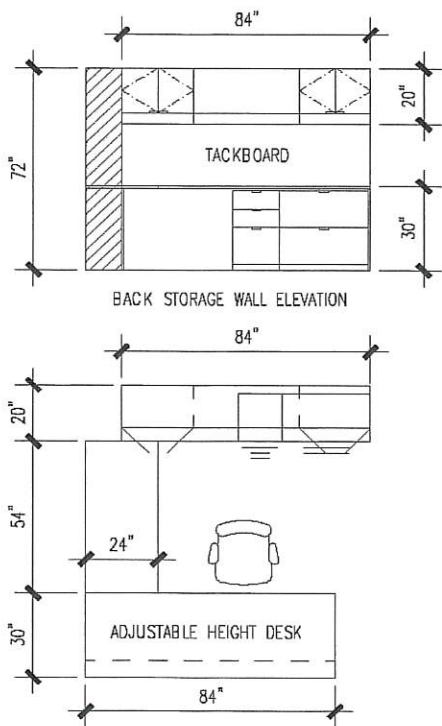

## FURNITURE SPECIFICATION SHEET

MSB Station 6-1 Renovation and Addition  
Wasilla, Alaska

### CHIEF OFFICE

Item Name: File Cabinet  
Floor Plan Code: F29  
Manufacturer: Knoll  
Product Name: Series 2 Laminate Front Floorstanding Pedestal  
Model Number:  
Dimensions: 14-7/8"W x 17-1/4"D x 26-3/8"H  
Description: Laminate front with metal case;  
Box/Box/File (BBF) configuration; locks  
keyed per each work station

Finishes: Plastic laminate cabinets and drawer  
fronts  
Powder-coated steel cabinet

Quantity: 1



Shown on left side.

### CHIEF OFFICE

Item Name: Lateral File Cabinet  
Floor Plan Code: F26  
Manufacturer: Knoll  
Product Name: Series 2 Laminate Front Double Wide Pedestal  
Model Number:  
Dimensions: 30"W x 18-3/4"D x 26-7/8"H  
Description: Laminate front with metal case;  
File/File (FF) configuration; locks keyed  
per each work station

Finishes: Plastic laminate cabinets and drawer  
fronts  
Powder-coated steel cabinet

Quantity: 1



Shown on right side.

## FURNITURE SPECIFICATION SHEET

MSB Station 6-1 Renovation and Addition  
Wasilla, Alaska

### CHIEF OFFICE and DAY ROOM

Item Name: Bookcase  
Floor Plan Code: F23  
Manufacturer: Knoll  
Product Name: Reff Profiles Bookcase & Hinge Doors  
Model Number:  
Dimensions: 36"W x 20"D x 71-3/8"H  
Description: Cabinet with hinged doors at bottom  
and open, adjustable shelves at top

Finishes: Plastic laminate cabinet, door faces,  
and shelves

Quantity: 2

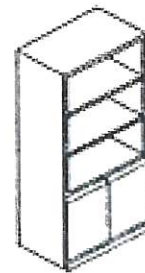
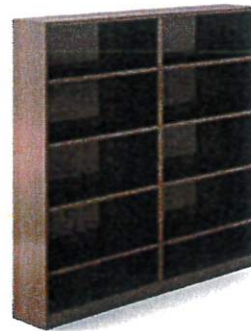

All plastic laminate Knoll Reff Profiles furnishings carry a  
Lifetime Manufacturer's Warranty.

### CHIEF OFFICE

Item Name: Meeting Table 1  
Floor Plan Code: F11-1  
Manufacturer: Knoll  
Product Name: Dividends Horizon X-Base Table  
Model Number:  
Dimensions: 42"W x 42"D x 28.5"H  
Description:

Finishes: Plastic laminate work surface  
  
Painted Steel Base in Silver

Quantity: 1

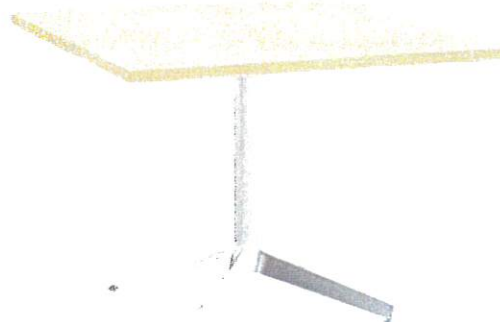



# FURNITURE SPECIFICATION SHEET

MSB Station 6-1 Renovation and Addition  
Wasilla, Alaska

## DEPUTY CHIEF OFFICE and HEALTH & SAFETY OFFICE

Item Name: Workstation 2  
Floor Plan Code: F20-2  
Manufacturer: Knoll  
Product Name: Reff Profiles  
Model Number:  
Dimensions: See Plan Below  
Description: L-Shaped 7'-0"W x 7'-0"D workstation;  
30" x 84" electric height adjustable  
work surface with full height modesty  
panel; wall mounted overhead storage  
cabinets with open cubbies and shelf;  
tackboard between overhead storage  
cabinets and work surface

Finishes: Plastic laminate work surfaces,  
cabinets, door and drawer fronts  
Powder coated steel supports

Quantity: 2

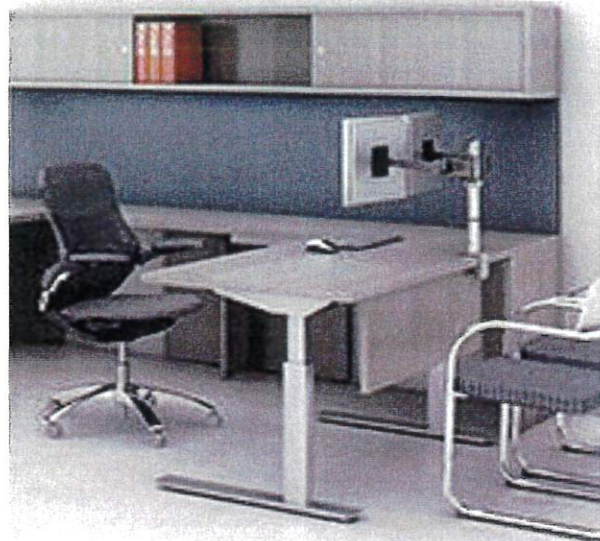

All plastic laminate Knoll Reff Profiles furnishings carry a  
Lifetime Manufacturer's Warranty.

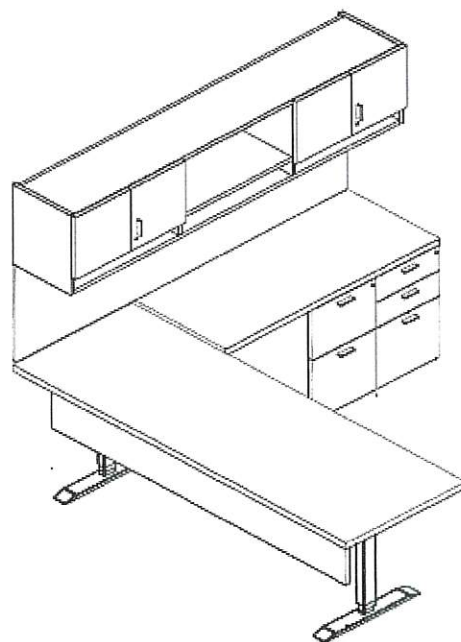
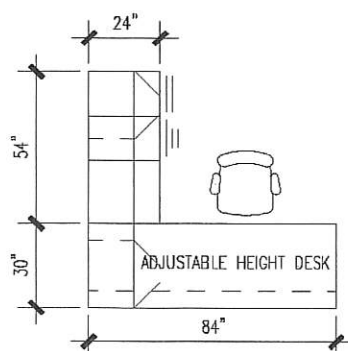
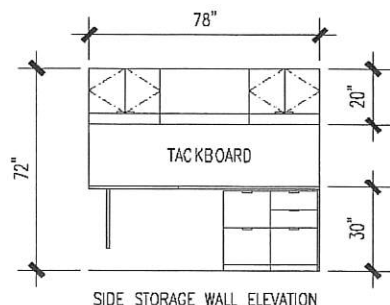

# FURNITURE SPECIFICATION SHEET

MSB Station 6-1 Renovation and Addition  
Wasilla, Alaska

## CAPTAIN OFFICES

Item Name: Workstation 3L  
Floor Plan Code: F20-3L (Left-Hand Return)  
Manufacturer: Knoll  
Product Name: Reff Profiles  
Model Number:  
Dimensions: See Plan Below  
Description: L-Shaped 6'-6"W x 5'-0"D workstation;  
wall mounted overhead storage  
cabinets with open cubbies; tackboard  
between overhead storage cabinets  
and work surface

Finishes: Plastic laminate work surfaces,  
cabinets, door and drawer fronts  
Powder coated steel supports

Quantity: 4



All plastic laminate Knoll Reff Profiles furnishings carry a  
Lifetime Manufacturer's Warranty.

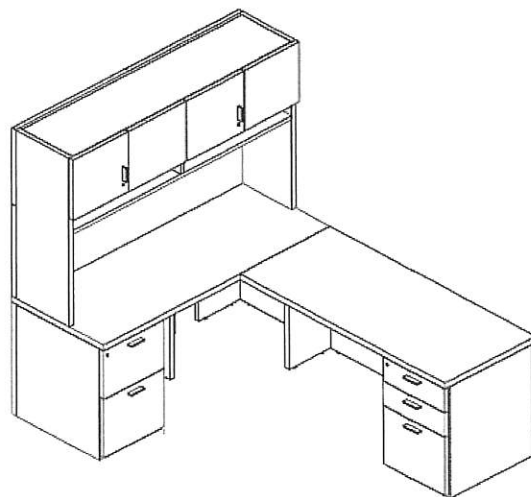
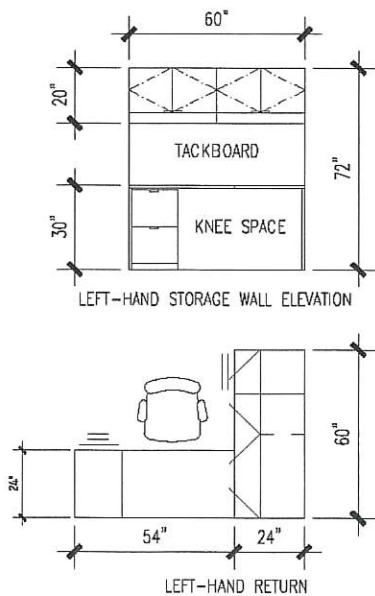

# FURNITURE SPECIFICATION SHEET

MSB Station 6-1 Renovation and Addition  
Wasilla, Alaska

## CAPTAIN OFFICES

Item Name: Workstation 3R  
Floor Plan Code: F20-3R (Right-Hand Return)  
Manufacturer: Knoll  
Product Name: Reff Profiles  
Model Number:  
Dimensions: See Plan Below  
Description: L-Shaped 6'-6"W x 5'-0"D workstation;  
wall mounted overhead storage  
cabinets with open cubbies; tackboard  
between overhead storage cabinets  
and work surface  
and work surface

Finishes: Plastic laminate work surfaces,  
cabinets, door and drawer fronts  
Powder coated steel supports

Quantity: 2



All plastic laminate Knoll Reff Profiles furnishings carry a  
Lifetime Manufacturer's Warranty.

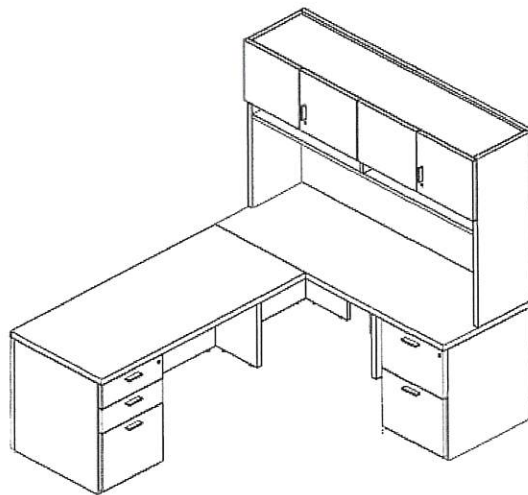
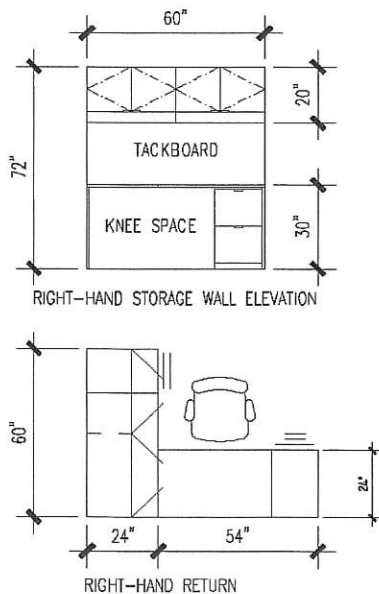



## FURNITURE SPECIFICATION SHEET

MSB Station 6-1 Renovation and Addition  
Wasilla, Alaska

### OFFICE SEATING

Item Name: Task Chair 1  
Floor Plan Code: F16  
Manufacturer: Knoll  
Product Name:  
Model Number:  
Dimensions: 27"D x 27"W adjustable height  
Description: Hight adjustable seat and arm rests;  
double-layer mesh back; synchronized  
tilt tension control; five-point tilt lock;  
waterfall edge

Finishes: Upholstered seat cushion  
Mesh seat back  
Powder-coated base

Quantity: 13



Twelve Year Manufacturer's Warranty

### OFFICE SEATING

Item Name: Task Chair 2  
Floor Plan Code: F17  
Manufacturer: Knoll  
Product Name: Life Chair  
Model Number:  
Dimensions: 24.5"D x 26.5"W adjustable height  
Description: Task chair with upholstered seat;  
mesh seat back with lumbar support;  
adjustable seat depth and height;  
armrests with adjustable height,  
depth, and width; reclining seat back  
with tilt lock; carpet casters

Finishes: Upholstered seat cushion  
Mesh seat back  
Polished aluminum base and arms

Quantity: 11



Twelve Year Manufacturer's Warranty



## FURNITURE SPECIFICATION SHEET

MSB Station 6-1 Renovation and Addition  
Wasilla, Alaska

### OFFICE SEATING

Item Name: Side Chair  
Floor Plan Code: F18  
Manufacturer: Knoll  
Product Name: Ollo Chair (Armless)  
Model Number:  
Dimensions: 23.5"W x 23"D adjustable height  
Description: Height adjustable pneumatic cylinder;  
lower back structured to provide  
lumbar support; upper back flexes to  
accommodate movement; generous  
seat cushion for extended comfort

Finishes: Upholstered seat cushion  
Polished aluminum base

Quantity: 8



Shown with arms - specified armless.  
Twelve Year Manufacturer's Warranty

### MEDIC 1

Item Name: Meeting Table 2  
Floor Plan Code: F11-2  
Manufacturer: Knoll  
Product Name: Dividends Horizon X-Base Table  
Model Number:  
Dimensions: 36" DIA x 28.5"H  
Description:

Finishes: Plastic laminate work surfaces and  
cabinets  
Painted steel base in Silver

Quantity: 1



AM 20-087

## FURNITURE SPECIFICATION SHEET

MSB Station 6-1 Renovation and Addition  
Wasilla, Alaska

### RECEPTION LOBBY

Item Name: Bench  
Floor Plan Code: F19  
Manufacturer: KI  
Product Name: Hub Armless Lounge H43  
Model Number:  
Dimensions: 26"L x 26"W x 30.25"H  
Description: Upholstered armless bench with backrest; modular units ganged to make continuous bench seat or can be used as single armless seats

Finishes: Vinyl seat upholstery  
Textile backrest upholstery

Quantity: 2



### RECEPTION AREA

Item Name: Adjustable Height Foot Rest  
Floor Plan Code: F27  
Manufacturer: Steelcase  
Product Name: Footrest  
Model Number: 13-0003085  
Dimensions:  
Description: Four height positions from 2" to 6" from floor;

Finishes: Non-skid black vinyl

Quantity: 1



## FURNITURE SPECIFICATION SHEET

MSB Station 6-1 Renovation and Addition  
Wasilla, Alaska

### RECEPTION AREA

Item Name: Lateral File  
Floor Plan Code: F22-1  
Manufacturer: Knoll  
Product Name: Calibre Laminate Front Lateral Files  
Model Number:  
Dimensions: 30"W x 18"D x 27"H  
Description: 2-drawer, metal lateral file cabinets with laminate fronts; lockable

Finishes: Metal cabinet  
Plastic laminate fronts  
Metal interior

Quantity: 3



### RECEPTION AREA

Item Name: Lateral File / Storage Cabinet  
Floor Plan Code: F22-2  
Manufacturer: Knoll  
Product Name: Reff Profiles Cabinet  
Model Number:  
Dimensions: 30"W x 20"D x 72.5"H  
Description: Storage cabinet with upper hinged doors and two adjustable shelves; two lateral files; laminate cabinet and fronts; metal interior; lockable

Finishes: Plastic laminate cabinet and drawer fronts  
Metal interior

Quantity: 2



All plastic laminate Knoll Reff Profiles furnishings carry a Lifetime Manufacturer's Warranty.

*AM 20-087*



## FURNITURE SPECIFICATION SHEET

MSB Station 6-1 Renovation and Addition  
Wasilla, Alaska

### ADMINISTRATIVE OFFICES

Item Name: Mobile Pedestal File Cabinet  
Floor Plan Code: F25  
Manufacturer: Knoll  
Product Name: Series 2  
Model Number: BS2PML24AL  
Dimensions: 14-7/8"W x 22-3/4"D x 26-3/8"H  
Description: Laminate front with metal case;  
Box/Box/File (BBF) configuration; locks  
keyed per each work station

Finishes: Metal cabinet  
Plastic laminate fronts  
Metal interior

Quantity: 10



### ADMINISTRATIVE OFFICES

Item Name: Mobile Pedestal File Cabinet  
Floor Plan Code: F26  
Manufacturer: Knoll  
Product Name: Series 2  
Model Number: BS2PML24BL  
Dimensions: 14-7/8"W x 22-3/4"D x 26-3/8"H  
Description: Laminate front with metal case;  
File/File (FF) configuration; locks keyed  
per each work station

Finishes: Metal cabinet  
Plastic laminate fronts  
Metal interior

Quantity: 8

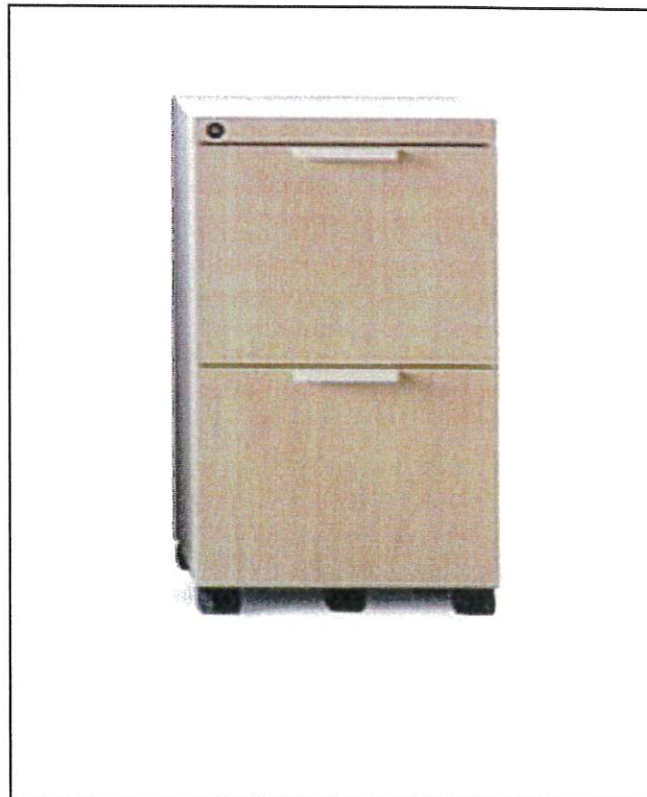

*AM 20-087*



## FURNITURE SPECIFICATION SHEET

MSB Station 6-1 Renovation and Addition  
Wasilla, Alaska

### DECON

Item Name: Bench  
Floor Plan Code: F31  
Manufacturer: Smith Steelworks  
Product Name: Backless Bench  
Model Number:  
Dimensions: 4' Wide  
Description: Powder-coated steel bench with bolt-down capability

Finishes: Color to be selected

Quantity: 1

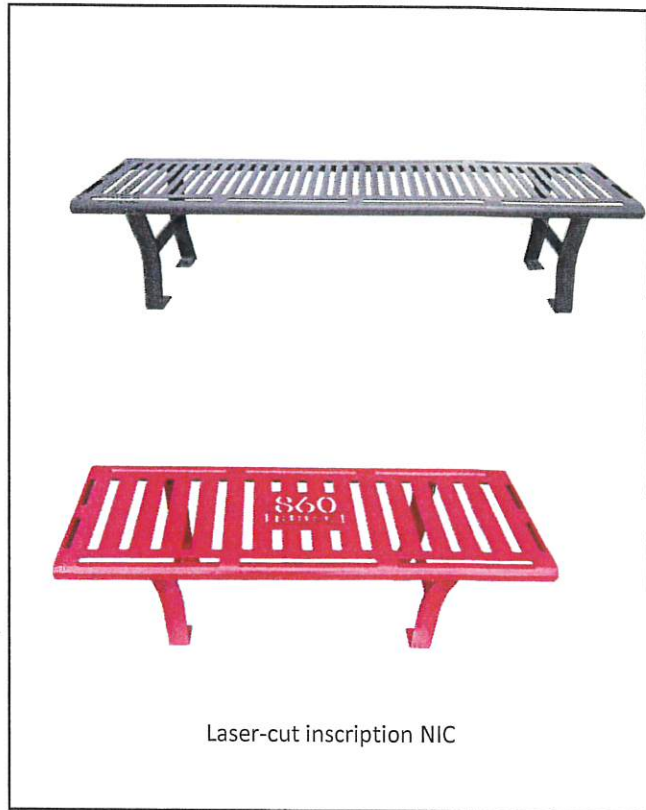

### ALL WORK STATIONS and BUILT-IN DESKS

Item Name: Under-Counter Adjustable CPU Holder  
Floor Plan Code: F28  
Manufacturer: Knoll  
Product Name: Sling CPU Holder  
Model Number:  
Dimensions:  
Description: Sling to fit CPU mini tower measuring 7" x 7.25" x 1.5"; rotatable 360 degrees for ease of accessibility

Finishes:

Quantity: 24

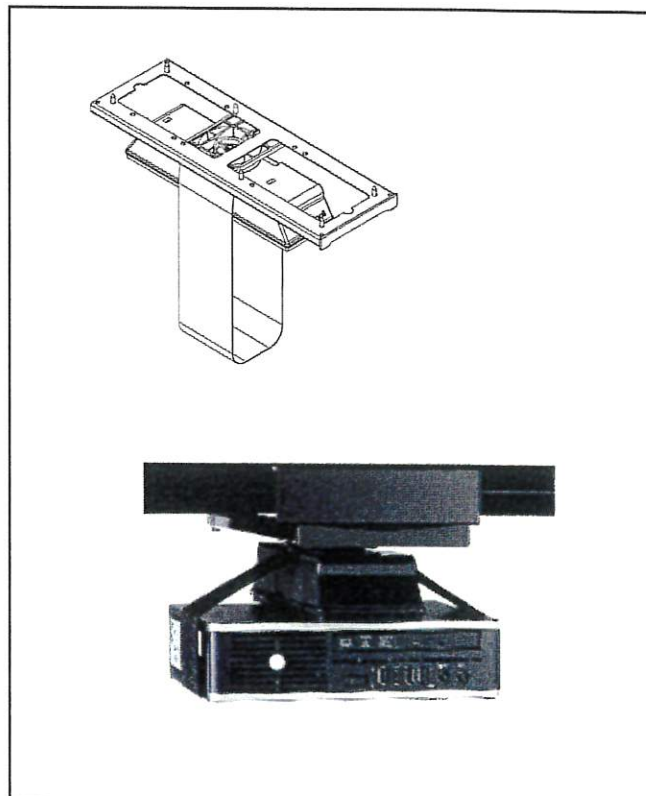

## Schedule "B"

### Roller Window Shades Specifications

*Am 20-087*

## **SECTION 12 24 10**

### **ROLLER WINDOW SHADES**

#### **PART 1 - GENERAL**

##### **1.1 RELATED DOCUMENTS**

- A. Drawings and general provisions of the Contract, including General and Supplementary Conditions and Division 01 Specification Sections, apply to this Section.

##### **1.2 SUMMARY**

- A. Section Includes:
  - 1. Manually operated roller blinds with single rollers as identified on floor plans.

##### **1.3 ACTION SUBMITTALS**

- A. Product Data: For each type of product.
  - 1. Include styles, material descriptions, construction details, dimensions of individual components and profiles, features, finishes, and operating instructions for roller shades.
- B. Samples for Initial Selection: For each type and color of shadeband material.
  - 1. Include Samples of accessories involving color selection.
- C. Roller-Shade Schedule: Use same designations indicated on Drawings.

##### **1.4 INFORMATIONAL SUBMITTALS**

- A. Product Certificates: For each type of shadeband material, signed by product manufacturer.

##### **1.5 CLOSEOUT SUBMITTALS**

- A. Maintenance Data: For roller shades to include in maintenance manuals.

## **1.6 QUALITY ASSURANCE**

- A. Installer Qualifications: Two years installation experience.

## **1.7 DELIVERY, STORAGE, AND HANDLING**

- A. Deliver roller shades in factory packages, marked with manufacturer, product name, and location of installation using same designations indicated on Drawings.

## **1.8 FIELD CONDITIONS**

- A. Environmental Limitations: Do not install roller shades until construction and finish work in spaces, including painting, is complete and dry and ambient temperature and humidity conditions are maintained at the levels indicated for Project when occupied for its intended use.
- B. Field Measurements: Where roller shades are indicated to fit to other construction, verify dimensions of other construction by field measurements before fabrication and indicate measurements on Shop Drawings. Allow clearances for operating hardware of operable glazed units through entire operating range. Notify Architect of installation conditions that vary from Drawings. Coordinate fabrication schedule with construction progress to avoid delaying the Work.

## **PART 2 - PRODUCTS**

### **2.1 MANUFACTURERS**

- A. Manufacturers: Subject to compliance with requirements, provide products by the following:
  - 1. Hunter Douglas Contract.
  - 2. Lutron Electronics Co., Inc.
  - 3. MechoShade Systems, Inc.
  - 4. OEM Shades Inc.
- B. Source Limitations: Obtain roller shades from single source from single manufacturer.

### **2.2 MANUALLY OPERATED, SINGLE-ROLLER SHADES**

- A. Rollers: Corrosion-resistant steel or extruded-aluminum tubes of diameters and wall thicknesses required to accommodate operating mechanisms and weights and widths of shadebands indicated without deflection. Provide with permanently lubricated drive-end assemblies and idle-end assemblies designed to facilitate removal of shadebands for service.



1. Roller Drive-End Location: Right side of inside face of shade
  2. Direction of Shadeband Roll: Regular, from back of roller
  3. Shadeband-to-Roller Attachment: Manufacturer's standard method
- B.** Mounting Hardware: Brackets or endcaps, corrosion resistant and compatible with roller assembly, operating mechanism, installation accessories, and mounting location and conditions indicated.
- C.** Shadebands:
1. Shadeband Material: Light-filtering fabric and Light-blocking fabric.
  2. Shadeband Bottom (Hem) Bar: Steel or extruded aluminum.
    - a. Type: Enclosed in sealed pocket of shadeband material
    - b. Color and Finish: As selected by Architect from manufacturer's full range
- D.** Installation Accessories:
1. Recessed Shade Pocket: Rectangular, extruded-aluminum enclosure designed for recessed ceiling installation; with front, top, and back formed as one piece, end plates, and removable bottom closure panel.
    - a. Height: Manufacturer's standard height required to enclose roller and shadeband when shade is fully open, but not less than 4 inches
    - b. Provide pocket with lip at lower edge to support acoustical ceiling panel.
  2. Installation Accessories Color and Finish: As selected from manufacturer's full range

## **2.3 SHADE AND MATERIALS**

- A.** Shadeband Material Flame-Resistance Rating: Comply with NFPA 701. Testing by a qualified testing agency. Identify products with appropriate markings of applicable testing agency.
- B.** Light-Filtering Fabric: Woven fabric, stain and fade resistant. (Admin/Office Areas)
1. Source: Roller-shade manufacturer
  2. Type: Woven PVC-coated fiberglass and PVC-coated polyester
  3. Weave: Mesh
  4. Roll Width: See drawings
  5. Orientation on Shadeband: Up the bolt
  6. Openness Factor: 10 percent.
  7. Color: As selected by Architect from manufacturer's full range
- C.** Light-Blocking Fabric: Opaque fabric, stain and fade resistant. (Sleeping Rooms only)
1. Source: Roller-shade manufacturer

2. Type: Fiberglass textile with PVC film bonded to both sides
3. Roll Width: See drawings
4. Orientation on Shadeband: Up the bolt
5. Features: Washable, Antistatic treatment
6. Color: As selected by Architect from manufacturer's full range

## **2.4 ROLLER-SHADE FABRICATION**

- A. Product Safety Standard: Fabricate roller shades to comply with WCMA A 100.1, including requirements for flexible, chain-loop devices; lead content of components; and warning labels.
- B. Unit Sizes: Fabricate units in sizes to fill window and other openings as follows, measured at 74 deg F (23 deg C):
  1. Between (Inside) Jamb Installation: Width equal to jamb-to-jamb dimension of opening in which shade is installed less 1/4 inch (6 mm) per side or 1/2-inch (13-mm) total, plus or minus 1/8 inch (3.1 mm). Length equal to head-to-sill or -floor dimension of opening in which shade is installed less 1/4 inch (6 mm), plus or minus 1/8 inch (3.1 mm).
  2. Outside of Jamb Installation: Width and length as indicated, with terminations between shades of end-to-end installations at centerlines of mullion or other defined vertical separations between openings.
- C. Shadeband Fabrication: Fabricate shadebands without battens or seams to extent possible except as follows:
  1. Vertical Shades: Where width-to-length ratio of shadeband is equal to or greater than 1:4 provide battens and seams at uniform spacings along shadeband length to ensure shadeband tracking and alignment through its full range of movement without distortion of the material.

## **PART 3 - EXECUTION**

### **3.1 EXAMINATION**

- A. Examine substrates, areas, and conditions, with Installer present, for compliance with requirements for installation tolerances, operational clearances, accurate locations of connections to building electrical system, and other conditions affecting performance of the Work.
- B. Proceed with installation only after unsatisfactory conditions have been corrected.

### **3.2 ROLLER-SHADE INSTALLATION**

- A. Install roller shades level, plumb, and aligned with adjacent units according to manufacturer's written instructions.
  - 1. Opaque Shadebands: Located so shadeband is not closer than 2 inches to interior face of glass. Allow clearances for window operation hardware.
- B. Electrical Connections: Connect motor-operated roller shades to building electrical system.

### **3.3 ADJUSTING**

- A. Adjust and balance roller shades to operate smoothly, easily, safely, and free from binding or malfunction throughout entire operational range.

### **3.4 CLEANING AND PROTECTION**

- A. Clean roller-shade surfaces after installation, according to manufacturer's written instructions.
- B. Provide final protection and maintain conditions, in a manner acceptable to manufacturer and Installer, that ensure that roller shades are without damage or deterioration at time of Substantial Completion.
- C. Replace damaged roller shades that cannot be repaired, in a manner approved by Architect, before time of Substantial Completion.

### **3.5 DEMONSTRATION**

- A. Engage a factory-authorized service representative to train Owner's maintenance personnel to adjust, operate, and maintain motor-operated roller shades.

**END OF SECTION 12241**

## Schedule "E"

### Residential Appliances Specifications

AM 20-087



## **SECTION 11 30 13**

### **RESIDENTIAL APPLIANCES**

#### **PART 1 - GENERAL**

##### **1.1 RELATED DOCUMENTS**

- A. Drawings and general provisions of the Contract, including General and Supplementary Conditions and Division 01 Specification Sections, apply to this Section.

##### **1.2 SUMMARY**

- A. Section Includes:
  - 1. Residential Grade Cooking appliances.
  - 2. Residential Grade Refrigeration/Freezer appliances.
  - 3. Residential Grade Cleaning appliances.

##### **1.3 ACTION SUBMITTALS**

- A. Product Data: For each type of product indicated. Include rated capacities, operating characteristics, dimensions, furnished accessories, and finishes for each appliance.
  - 1. Product Data: For appliances indicated, documentation that products are ENERGY STAR rated.
  - 2. Product Data: For water-efficient clothes washer documentation indicating modified energy factor and water factor.
- B. Samples: For each exposed product and for each color and texture specified, in manufacturer's standard size.
- C. Product Schedule: For appliances. Use same designations indicated on Drawings.

##### **1.4 INFORMATIONAL SUBMITTALS**

- A. Qualification Data: For qualified manufacturer.
- B. Product Certificates: For each type of appliance, from manufacturer.
- C. Field quality-control reports.

- D. Warranties: Sample of special warranties.

## 1.5 CLOSEOUT SUBMITTALS

- A. Operation and Maintenance Data: For each residential appliance to include in operation and maintenance manuals.

## 1.6 QUALITY ASSURANCE

- A. Manufacturer Qualifications: Maintains, within 2 hours of Project site, a service center capable of providing training, parts, and emergency maintenance repairs.
- B. Installer Qualifications: An employer of workers trained and approved by manufacturer for installation and maintenance of units required for this Project.
- C. Source Limitations: Obtain residential appliances from single source and manufactured by a single manufacturer within a single product line.
- D. Regulatory Requirements: Comply with the following:
  - 1. NFPA: Provide electrical appliances listed and labeled as defined in NFPA 70, by a qualified testing agency, and marked for intended location and application.
- E. Accessibility: Where residential appliances are indicated to comply with accessibility requirements, comply with the U.S. Architectural & Transportation Barriers Compliance Board's ADA-ABA Accessibility Guidelines and ICC/ANSI A117.1
- F. Preinstallation Conference: Conduct conference at Project site

## 1.7 WARRANTY

- A. Special Warranties: Manufacturer's standard form in which manufacturer agrees to repair or replace residential appliances or components that fail in materials or workmanship within specified warranty period except as qualified below:
  - 1. Warranty Period: Two years from date of Substantial Completion.
- B. Electric Range: Full warranty including parts and labor for on-site service on surface-burner elements.
  - 1. Warranty Period: Two years from date of Substantial Completion.
- C. Microwave Oven: Full warranty including parts and labor for on-site service
  - 1. Warranty Period: Two years from date of Substantial Completion.

- D. Refrigerator/Freezer and Icemaker], Sealed System: Full warranty including parts and labor for on-site service on the product.
  - 1. Warranty Period for Two years from date of Substantial Completion.
- E. Dishwasher: Full warranty including parts and labor for on-site service on the product.
  - 1. Warranty Period for Three years from date of Substantial Completion.
- F. Clothes Washer: Full warranty including parts and labor for on-site service on the product.
  - 1. Warranty Period: Two years from date of Substantial Completion.

## **PART 2 - PRODUCTS**

### **2.1 OVENS / RANGES / COOKTOPS**

- A. Manufacturers: Subject to compliance with requirements, manufacturers offering products that may be incorporated into the Work include, but are not limited to, the following:
- B. Basis-of-Design Product: Subject to compliance with requirements, provide product indicated or comparable product by one of the following:
  - 1. Amana; a division of Whirlpool Corporation.
  - 2. BOSCH Home Appliances.
  - 3. Electrolux Home Products (Frigidaire).
  - 4. Fisher & Paykel.
  - 5. General Electric Company (GE).
  - 6. General Electric Company (Hotpoint).
  - 7. Jenn-Air; a division of Whirlpool Corporation.
  - 8. KitchenAid; a division of Whirlpool Corporation.
  - 9. LG Appliances.
  - 10. Maytag; a division of Whirlpool Corporation.
  - 11. Sears Brands LLC (Kenmore).
  - 12. Sharp Electronics Corp.
  - 13. Viking Range Corporation.
  - 14. Whirlpool Corporation.
  - 15. Wolf Appliance, Inc.
- 1. Range: R1:
  - a. GE Profile 30" Dbl Oven Convection Range Model PGS960SELSS
  - b. Location: Kitchen 143
  - c. traditional Upper/ Convection Lower

d. Finish: Glass/Stainless Steel

**2. Double Wall Oven R2:**

- a. GE Profile 30" Dbl Wall Oven Model PTD7000SNSS
- b. Location: Kitchen 143
- c. Convection Upper/Convection Lower
- d. Electric
- e. Finish: Glass/Stainless Steel

**3. Cooktop CT1:**

- a. GE Profile 36" Built In Gas Cooktop, Model PGP9036SLSS
- b. Location: Kitchen 143
- c. 5 Sealed Burners
- d. Finish: Cast Grilles /Stainless Steel
- e. Front Mount Controls

4. Substitutions acceptable per requirements of Division 01600

**2.2 MICROWAVE OVENS**

A. Manufacturers: Subject to compliance with requirements, available manufacturers offering products that may be incorporated into the Work include, but are not limited to, the following:

B. Basis-of-Design Product: Subject to compliance with requirements, provide product indicated or comparable product by one of the following:

- 1. Amana; a division of Whirlpool Corporation.
- 2. BOSCH Home Appliances.
- 3. Electrolux Home Products (Frigidaire).
- 4. General Electric Company (GE).
- 5. General Electric Company (Hotpoint).
- 6. Jenn-Air; a division of Whirlpool Corporation.
- 7. KitchenAid; a division of Whirlpool Corporation.
- 8. LG Appliances.
- 9. Maytag; a division of Whirlpool Corporation.
- 10. Sears Brands LLC (Kenmore).
- 11. Sharp Electronics Corp.
- 12. Viking Range Corporation.
- 13. Whirlpool Corporation.
- 14. Wolf Appliance, Inc.

**C. Microwave: MO1 / MO2 / MO3:**

- 1. General Electric Model PES7227SLSS



2. Location: Kitchen 143 / Break 207
  - a. Convection Upper/Convection Lower
  - b. Finish: Glass/Stainless Steel
  - c. Depth 19.75:
  - d. Height 14"
  - e. Width: 24.125"
  - f. Capacity: 2.2 Cu Ft
3. Substitutions acceptable per requirements of Division 01600

### 2.3 REFRIGERATOR/FREEZER

- A. Manufacturers: Subject to compliance with requirements, available manufacturers offering products that may be incorporated into the Work include, but are not limited to, the following:
- B. Basis-of-Design Product: Subject to compliance with requirements, provide product indicated or comparable product by one of the following:
  1. Amana; a division of Whirlpool Corporation.
  2. BOSCH Home Appliances.
  3. Electrolux Home Products (Frigidaire).
  4. Fisher & Paykel.
  5. General Electric Company (GE).
  6. General Electric Company (Hotpoint).
  7. Jenn-Air; a division of Whirlpool Corporation.
  8. KitchenAid; a division of Whirlpool Corporation.
  9. LG Appliances.
  10. Maytag; a division of Whirlpool Corporation.
  11. Samsung.
  12. Sears Brands LLC (Kenmore).
  13. Viking Range Corporation.
  14. Whirlpool Corporation.
- C. Two Door Refrigerator/Freezer R1, R2, R3, R4, R5
  1. Basis-of-Design Product: GE Profile Model PYE22KSKSS
  2. Type: Freestanding
  3. Location:
    - a. Kitchen 143 – R1, R2, R3, R4
    - b. Break 207 – R5
  4. Capacity:
    - a. Total: 22.2 cf
    - b. Refrigerator: 15.07 cf
    - c. Freezer: 7.16cf

5. General Features:
  - a. Separate temperature controls for each compartment.
  - b. Counter depth
  - c. Interior lights
6. Dimensions:
  - a. Width: 35 3/4".
  - b. Depth: 24 3/8 (case depth)
  - c. Height 69 7/8"
7. Energy Performance, ENERGY STAR: Provide appliances that qualify for the EPA/DOE ENERGY STAR product labeling program.
8. Appliance Color/Finish: Stainless Steel
9. Substitutions acceptable per requirements of Division 01600

## 2.4 DISHWASHES

- A. Manufacturers: Subject to compliance with requirements, manufacturers offering products that may be incorporated into the Work include, but are not limited to, the following:
- B. Basis-of-Design Product: Subject to compliance with requirements, provide product indicated or comparable product by one of the following:
  1. Amana; a division of Whirlpool Corporation.
  2. ASKO North America; a division of AM Appliance Group.
  3. BOSCH Home Appliances.
  4. Electrolux Home Products (Frigidaire).
  5. Fisher & Paykel.
  6. General Electric Company (GE).
  7. General Electric Company (Hotpoint).
  8. Jenn-Air; a division of Whirlpool Corporation.
  9. KitchenAid; a division of Whirlpool Corporation.
  10. LG Appliances.
  11. Maytag; a division of Whirlpool Corporation.
  12. Miele, Inc.
  13. Sears Brands LLC (Kenmore).
  14. Viking Range Corporation.
  15. Whirlpool Corporation.
- C. Dishwasher DW1 , DW2
  1. Basis-of-Design Product: GE Profile, Model PDT785SYNFS
  2. Type: Built-in undercounter
  3. Dimensions:

- a. Width: 24"
  - b. Depth: 23 ¾"
  - c. Height: 34"
4. Sound Level: Maximum 45dB.
5. Energy Performance, ENERGY STAR: Provide appliances that qualify for the EPA/DOE ENERGY STAR product labeling program.
6. Appliance Color/Finish: Stainless
7. Substitutions acceptable per requirements of Division 01600

## **2.5 CLOTHES WASHER/DRYER COMBINATIONS**

- A. Manufacturers: Subject to compliance with requirements, manufacturers offering products that may be incorporated into the Work include, but are not limited to, the following:
- B. Basis-of-Design Product: Subject to compliance with requirements, provide product indicated or comparable product by one of the following:
  1. ASKO North America; a division of AM Appliance Group.
  2. Electrolux Home Products (Frigidaire).
  3. Fisher & Paykel.
  4. General Electric Company (GE).
  5. General Electric Company (Hotpoint).
  6. LG Appliances.
  7. Maytag; a division of Whirlpool Corporation.
  8. Sears Brands LLC (Kenmore).
  9. Thor Appliance Company.
  10. Whirlpool Corporation.
- C. Clothes Washer/Dryer Combination CWD 1
  1. Basis-of-Design Product: Whirlpool S Front Load Washer Model WFW8620HC
  2. Type: Freestanding washer unit with dual-drum design and electric dryer]; washer is front loading.
  3. Front Load Washer
    - a. Capacity: 5 cf
  4. Dimensions:
    - a. Width: 27"
    - b. Depth: 33 1/4"
    - c. Height: 38 5/8"
  5. Basis-of-Design Product: Whirlpool Front Load Gas Dryer Model WWGd6620HC
  6. Front Load Dryer

- a. Capacity: 7.25cf
- 7. Dimensions:
  - a. Width: 27"
  - b. Depth: 31"
  - c. Height: 38.75"
- 8. Energy Performance, ENERGY STAR: Provide appliances that qualify for the EPA/DOE ENERGY STAR product labeling program.
- 9. Water-Efficient Clothes Washer: Provide clothes washer with modified energy factor greater than or equal to 2.0 and water factor less than 5.5.
- 10. Appliance Finish: Porcelain enamel on top and lid; baked enamel on front and sides
  - a. Color: Stainless/Silver

## **2.6 GENERAL FINISH REQUIREMENTS**

- A. Protect mechanical finishes on exposed surfaces from damage by applying a strippable, temporary protective covering before shipping.
- B. Appearance of Finished Work: Noticeable variations in same piece are not acceptable. Variations in appearance of adjoining components are acceptable if they are within the range of approved Samples and are assembled or installed to minimize contrast.

## **2.7 INSTALLATION, GENERAL**

- A. General: Comply with manufacturer's written instructions.
- B. Built-in Equipment: Securely anchor units to supporting cabinets or countertops with concealed fasteners. Verify that clearances are adequate for proper functioning and that rough openings are completely concealed.
- C. Freestanding Equipment: Place units in final locations after finishes have been completed in each area. Verify that clearances are adequate to properly operate equipment.
- D. Range Anti-Tip Device: Install at each range according to manufacturer's written instructions.
- E. Utilities: Comply with plumbing and electrical requirements.

## **2.8 FIELD QUALITY CONTROL**

- A. Perform tests and inspections.



1. Manufacturer's Field Service: Engage a factory-authorized service representative to inspect components, assemblies, and equipment installations, including connections, and to assist in testing.

**B. Tests and Inspections:**

1. Perform visual, mechanical, and electrical inspection and testing for each appliance according to manufacturers' written recommendations. Certify compliance with each manufacturer's appliance-performance parameters.
2. Leak Test: After installation, test for leaks. Repair leaks and retest until no leaks exist.
3. Operational Test: After installation, start units to confirm proper operation.
4. Test and adjust controls and safeties. Replace damaged and malfunctioning controls and components.

**C.** An appliance will be considered defective if it does not pass tests and inspections.

**D.** Prepare test and inspection reports.

**END OF SECTION 11 30 13**



## MATANUSKA-SUSITNA BOROUGH Purchasing Division

350 East Dahlia Avenue • Palmer, AK 99645  
Phone (907) 861-8601 • Fax (907) 861-8617

[purchasing@matsugov.us](mailto:purchasing@matsugov.us)  
[www.matsugov.us](http://www.matsugov.us)

### Recommendation of Award and Distribution of Funds

Solicitation Number: 21-006B

Entitled: Supply and Install FFE at Station 6-1

Wednesday, July 29, 2020

**TO:** Robert Scott, Project Manager, Capital Projects

**FROM:** Dustin Silva, Assistant Purchasing Officer, Purchasing

Bids for services of the above listed project were opened in the office of the Purchasing Officer on 7/24/2020 (3.08.220(F)). The bid is summarized below:

| Schedule A           |                  |       |
|----------------------|------------------|-------|
| Bidder               | Total Bid Amount | Award |
| Capital Office       | \$151,991.24     | YES   |
| Arctic Office        | \$155,916.00     | No    |
| Think Office         | \$176,314.98     | No    |
| Binw Ak              | \$201,309.77     | No    |
| Schedule B           |                  |       |
| Bidder               | Total Bid Amount | Award |
| Capital Office       | \$11,505.88      | YES   |
| Collins Construction | \$18,514.00      | No    |
| Schedule E           |                  |       |
| Bidder               | Total Bid Amount | Award |
| Collins Construction | \$75,327.00      | YES   |

Based on the above, the Matanuska-Susitna Borough Purchasing Division will award Schedules A & B to Capital Office in the amount of \$163,497.12 and Schedule E to Collins Construction in the amount of \$75,327.00 as the lowest responsive and responsible bidders.

The project area is located in Assembly District(s): 4. Funding for this project is identified below:

| Account Number      | Project-Source-Sub Project | Amount       |
|---------------------|----------------------------|--------------|
| 405.000.000 463.312 | 45066-6600-6662            | \$150,000.00 |
| Total:              |                            | \$238,824.12 |



Concur

\_\_\_\_\_  
(Project Manager Signature)

**Jude Bilafer**

Digitally signed by Jude Bilafer  
Date: 2020.08.05 09:10:54 -08'00'

\_\_\_\_\_  
(Director Signature)

Please mark, sign and return to Purchasing.

*AM 20-087*



# MATANUSKA-SUSITNA BOROUGH PURCHASING DIVISION

350 East Dahlia Avenue, Palmer, Alaska 99645-6488  
PHONE (907) 861-8601 • FAX (907) 861-8617  
EMAIL: Purchasing@MatSuGov.us

## MEMORANDUM

**"Information Only, Not Part of Legislation"**

**DATE:** 7/29/20  
**TO:** Rustin Krafft, Purchasing Officer  
**THRU:** Michael Newman, Assistant Comptroller  
**THRU:** Jude Bilafer, *CP Director*; Jeff Walden, *PM Lead/Manager*  
**FROM:** Robert Scott, Project Mgr II

Michael Newman  
Digitally signed by Michael Newman  
Date: 2020.08.02 18:51:35 -08'00'

**SUBJECT:** Request to Prepare Solicitation & Advertise/Fund Verification  
**TITLE:** Station 6-1 FFE Remodel (FY21)

Please prepare and issue solicitation documents for the project identified above. The scope of work/ Scope of Services, specifications, supplemental general conditions, drawings, plans and/or all other documents as may be required to issue the solicitation are being provided with this request and funding document.

This project ☐ is federal funded\*; ☐ is state funded\*; ☒ not state or federal funded (MSB funded).

\*If the project is subject to state or federal grant funding that requires special procurement provisions or terms, a copy of the grant may be required, if requested by the purchasing office.

|   |                |   |                    |                            |                          |
|---|----------------|---|--------------------|----------------------------|--------------------------|
| <b>Estimated Project Magnitude (\$)</b> |                | \$ 238,824.12                           |                    | <b>Assembly District #</b> | # 4                      |
| <b>Advertising Costs Account Number</b> |                | # 45066-6600-6662 / 405.000.000 463.940 |                    |                            |                          |
| <b>Account Number</b>                   | <b>Project</b> | <b>Source</b>                           | <b>Sub-Project</b> | <b>Amount</b>              | <b>Project Exp. Date</b> |
| 405.000.000 463.312                     | 45066          | 6600                                    | 6662               | 238,824.12                 | 6/30/23                  |
|   |                |   |                    |                            |                          |
|   |                |   |                    |                            |                          |
|   |                |   |                    |                            |                          |

**Robert Scott**  
Digitally signed by Robert Scott  
Date: 2020.07.29 15:14:34 -08'00'

PROJECT MANAGER/REQUESTOR

**Brad Sworts**  
Digitally signed by Brad Sworts  
Date: 2020.07.31 09:04:17 -08'00'

**Brad Sworts**  
Digitally signed by Brad Sworts  
Date: 2020.07.31 09:04:49 -08'00'

DEPARTMENT DIRECTOR/DIVISION MANAGER APPROVAL

**Michael Newman**  
Digitally signed by Michael Newman  
Date: 2020.08.02 18:51:35 -08'00'

VERIFYING SIGNATURE FROM ACCOUNTING DIVISION

☐ Funding is not currently available for this requirement. Information concerning the funding availability is provided below. The solicitation will be issued with a statement that funds are currently not available for this action. No action will be taken on bids or proposals received until funding is identified.

Ordinance # \_\_\_\_\_ Introduction Date \_\_\_\_\_  
Resolution # \_\_\_\_\_ Introduction Date \_\_\_\_\_

Public Hearing Date \_\_\_\_\_

**Approved 5/28/20**

Rev. 7/19

*AM 20-087*



# "Information Only, Not Part of Legislation"

FISCAL YEAR 2021  
Funding Source

| FUND | ACCT    | PROJ. | SUB       | RESO | DESCRIPTION OF APPROPRIATIONS   | Manager<br>Approved | Areawide | Non<br>Areawide | Service<br>Areas | Enterprise<br>Fund |
|------|---------|-------|-----------|------|---|---------------------|----------|-----------------|------------------|--------------------|
| 405  | 464.451 | 45238 | 6600-6606 |      | Station 13-1: Extend Emer. Gen. power to Second Warm Storage Bldg.  | 25,000              |          |                 | 25,000           |                    |
|      |         |       |           |      | CENTRAL MAT-SU FIRE DEPT / WASILLA LAKES FSA STATIONS 5-1, 5-2, 6-1, 6-2, 6-4, 6-5, 6-6 250,000,000 446,400 |                     |          |                 |                  |                    |
| 405  | 464.451 | 45066 | 6600-6602 |      | Station 6-1: FFE for remodel  | 250,000             |          |                 | 250,000          |                    |
| 405  | 464.451 | 45066 | 6600-6603 |      | Critical Response Unit & Related Equipment  | 375,000             |          |                 | 375,000          |                    |
| 405  | 464.451 | 45066 | 6600-6604 |      | Tactical Tender & Related Equipment   | 700,000             |          |                 | 700,000          |                    |
| 405  | 463.312 | 45076 | 6600-6605 |      | Training Complex Build Out  | 750,000             |          |                 | 750,000          |                    |
| 405  | 461.312 | 45076 | 6600-6606 |      | General Station Maintenance and upkeep to include painting  | 200,000             |          |                 | 200,000          |                    |
| 405  | 464.451 | 45066 | 6600-6605 |      | Replace Brush 6-6 Chassis and Purchase Command Vehicle & Related Equipment                                  | 200,000             |          |                 | 200,000          |                    |
| 405  | 464.451 | 45066 | 6600-6606 |      | Personal Protective Clothing & Equipment  | 150,000             |          |                 | 150,000          |                    |
| 405  | 464.451 | 45066 | 6600-6607 |      | Firefighting Foam / Chemicals   | 50,000              |          |                 | 50,000           |                    |
| 405  | 464.451 | 45066 | 6600-6608 |      | Unmanned Aerial Vehicle Program   | 50,000              |          |                 | 50,000           |                    |
|      |         |       |           |      | GREATER PALMER FSA STATIONS 3-1, 3-2, 3-3, 3-4, 3-5 259,000,000 446,400                                     |                     |          |                 |                  |                    |
| 405  | 464.451 | 45215 | 6600-6612 |      | Personal Protective Equipment (PPE)   | 90,000              |          |                 | 90,000           |                    |
| 405  | 461.000 | 45140 | 6600-6601 |      | Stations 32/33/35 Bathroom Remodels   | 60,000              |          |                 | 60,000           |                    |
| 405  | 464.451 | 45215 | 6600-6613 |      | Apparatus and Related Equipment Replacement   | 800,000             |          |                 | 800,000          |                    |
|      |         |       |           |      | SUTTON FSA STATION 1-1 253,000,000 446,400  |                     |          |                 |                  |                    |
| 405  | 464.451 | 45051 | 6600-6605 |      | Oil Heater in FSA & Annex   | 30,000              |          |                 | 30,000           |                    |
|      |         |       |           |      | WEST LAKES FSA ST. 8-1, 8-2, 7-1, 7-2, 7-3, 7-8 249,000,000 446,400   |                     |          |                 |                  |                    |
| 405  | 464.451 | 45244 | 6600-6651 |      | Station 8-1 Breathing Air Compressor  | 50,000              |          |                 | 50,000           |                    |
| 405  | 464.451 | 45244 | 6600-6652 |      | Station 7-9 Boiler Replacement  | 25,000              |          |                 | 25,000           |                    |
| 405  | 464.451 | 45244 | 6600-6653 |      | F-550 Replacement for Brush 71 & Related Equipment  | 100,000             |          |                 | 100,000          |                    |
| 405  | 464.451 | 45244 | 6600-6654 |      | Knox Key Secure Upgrades  | 25,000              |          |                 | 25,000           |                    |
|      |         |       |           |      | WILLOW FSA Station 12-1 & 12-2 258,000,000 446,400  |                     |          |                 |                  |                    |
| 405  | 463.312 | 45287 | 6600-6604 |      | Station 12-5 Water Storage Tank & Paving  | 100,000             |          |                 | 100,000          |                    |
| 405  | 463.312 | 45287 | 6600-6605 |      | Station 12-2 Winterizing: Fuel Tank, Generator, Overhead Doors  | 115,000             |          |                 | 115,000          |                    |
| 405  | 462.312 | 45287 | 6600-6606 |      | Station 12-2 Well Development   | 30,000              |          |                 | 30,000           |                    |
|      |         |       |           |      | ROAD SERVICE ADMINISTRATION EQUIPMENT 265,000,000 446,400   |                     |          |                 |                  |                    |
| 410  | 464.451 | 30092 | 6600-6623 |      | Variable Message Signboard  | 20,000              |          |                 | 20,000           |                    |
|      |         |       |           |      | ROAD SERVICE AREAS 446,400  | 0                   |          |                 |                  |                    |
| 410  | 462.XXX | 30036 | 6600-6600 |      | Midway - Fund 270   | 1,194,168           |          |                 | 1,194,168        |                    |
| 410  | 462.XXX | 30037 | 6600-6600 |      | Fairview - Fund 271   | 757,215             |          |                 | 757,215          |                    |
| 410  | 462.XXX | 30038 | 6600-6600 |      | Caswell Lakes - Fund 272  | 124,648             |          |                 | 124,648          |                    |
| 410  | 462.XXX | 30039 | 6600-6600 |      | South Colony - Fund 273   | 568,342             |          |                 | 568,342          |                    |
| 410  | 462.XXX | 30040 | 6600-6600 |      | Knik - Fund 274   | 1,599,090           |          |                 | 1,599,090        |                    |
| 410  | 462.XXX | 30041 | 6600-6600 |      | Lazy Mountain - Fund 275  | 124,953             |          |                 | 124,953          |                    |
| 410  | 462.XXX | 30042 | 6600-6600 |      | Greater Willow - Fund 276   | 387,055             |          |                 | 387,055          |                    |

AM 20-087