

SUBJECT: A RESOLUTION OF THE MATANUSKA-SUSITNA BOROUGH ASSEMBLY AUTHORIZING THE BOROUGH MANAGER TO SELL THE KASHWITNA EAST SALVAGE TIMBER HARVEST (MSB008103).

AGENDA OF: April 2, 2024

ASSEMBLY ACTION: Approved under the consent agenda 04/02/24 - BJH

AGENDA ACTION REQUESTED: Present to Assembly for consideration.

Route To	Signatures
Originator	<div style="text-align: center;">3 / 2 0 / 2 0 2 4</div> <hr/> X J o e M e t z g e r <hr/> <small>S i g n e d b y : J o e M e t z g e r</small>
Department Director	<div style="text-align: center;">3 / 2 0 / 2 0 2 4</div> <hr/> X G e o r g e W H a y s <hr/> <small>S i g n e d b y : G e o r g e H a y s</small>
Finance Director	<div style="text-align: center;">3 / 2 1 / 2 0 2 4</div> <hr/> X C h e y e n n e H e i n d e l <hr/> <small>S i g n e d b y : C h e y e n n e H e i n d e l</small>
Borough Attorney	<div style="text-align: center;">3 / 2 1 / 2 0 2 4</div> <hr/> X J o h n A s c h e n b r e n n e r <hr/> <small>S i g n e d b y : J o h n A s c h e n b r e n n e r</small>
Borough Manager	<div style="text-align: center;">3 / 2 1 / 2 0 2 4</div> <hr/> X M i c h a e l B r o w n <hr/> <small>S i g n e d b y : M i c h a e l B r o w n</small>
Borough Clerk	<div style="text-align: center;">3 / 2 2 / 2 0 2 4</div> <hr/> X L o n n i e M c K e c h n i e <hr/> <small>S i g n e d b y : L o n n i e M c K e c h n i e</small>

ATTACHMENT (S) : Fiscal Note (1pp)
 Kashwitna East Salvage Timber Harvest Map (1 pp)
 Resolution Serial No. 24-034 (1 pp)

SUMMARY STATEMENT: The Matanuska-Susitna Borough Land and Resource Management Division is proposing a salvage timber sale on approximately 145 acres of Borough-owned forestland on Borough parcels Tax ID 20N04W07A001 and 20N04W08A001. The parcels encompass approximately 657 acres, but only 145 acres are included in the proposed harvest area. This salvage harvest is a land conversion from forestland to a material site. A Borough Conditional Use Permit for material extraction was approved by the Planning Commission September 19, 2022. The timber harvest will help prepare the site.

There are an estimated 760 cords of timber consisting of a mix of birch, spruce, and aspen.

Pursuant to MSB 23.05.025, the public comment period was open from February 12 through March 14, 2024. No public comments were received.

This salvage sale is proposed to be offered over-the-counter on a first come first served basis, similar to the majority of previous timber sales.

A salvage harvest within the subject Borough parcel is being proposed to prepare the area for future material extraction.

These parcels are immediately south of the QAP material site located east of milepost 78 of the Parks Highway.

The proposal for the timber salvage sale was made to realize the maximum public benefit of the forestland before it is converted to a different land use.

RECOMMENDATION OF ADMINISTRATION:

Matanuska-Susitna Borough Assembly adoption of Resolution Serial No. 24-034 authorizing the Borough Manager to sell the Kashwitna East Salvage Timber Sale over-the-counter (MSB008103).

MATANUSKA-SUSITNA BOROUGH

FISCAL NOTE

Agenda Date: April 2, 2024

SUBJECT: A RESOLUTION OF THE MATANUSKA-SUSITNA BOROUGH ASSEMBLY AUTHORIZING THE BOROUGH MANAGER TO SELL THE KASHWITNA EAST SALVAGE TIMBER HARVEST (MSB008103).

FISCAL ACTION (TO BE COMPLETED BY FINANCE)	FISCAL IMPACT YES NO
AMOUNT REQUESTED *	FUNDING SOURCE Timber Sale
FROM ACCOUNT #	PROJECT
TO ACCOUNT: 203.000.000 3xx.xxx	PROJECT #
VERIFIED BY: 3 / 2 0 / 2 0 2 4 X <u>L i e s e l W e i l a n d</u> Signed by: L i e s e l W e i l a n d	

EXPENDITURES/REVENUES:

(Thousands of Dollars)

OPERATING	FY2024	FY2025	FY2026	FY2027	FY2028	FY2029
Personnel Services						
Travel						
Contractual						
Supplies						
Equipment						
Land/Structures						
Grants, Claims						
Miscellaneous						
TOTAL OPERATING						
CAPITAL						
REVENUE	*					

FUNDING:

(Thousands of Dollars)

General Fund						
State/Federal Funds						
Other	*					
TOTAL	*					

POSITIONS:

Full-Time						
Part-Time						
Temporary						

ANALYSIS: (Attach a separate page if necessary) * Amount depends on actual sale price of timber

APPROVED BY:	3 / 2 1 / 2 0 2 4
X <u>C h e y e n n e H e i n d e l</u>	

Signed by: C h e y e n n e H e i n d e l





**Matanuska - Susitna Borough
Land and Resource
Management Division**



**Kashwitna East
Timber Salvage**

**Vicinity
Map**

Legend

-  Kashwitna East Project Area
-  Affected MSB Parcels
-  Section Lines
-  Parcels

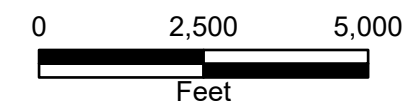
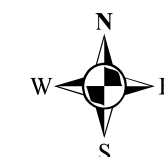

Date: February 2024
Sources: MSB GIS, MSB LRMD, AK DOT
Projection: NAD 83 AK ST PLN Z4
Location: MSB
Author: MSB LRMD/GIS

IM No. 24-067
Resolution Serial No. 24-034

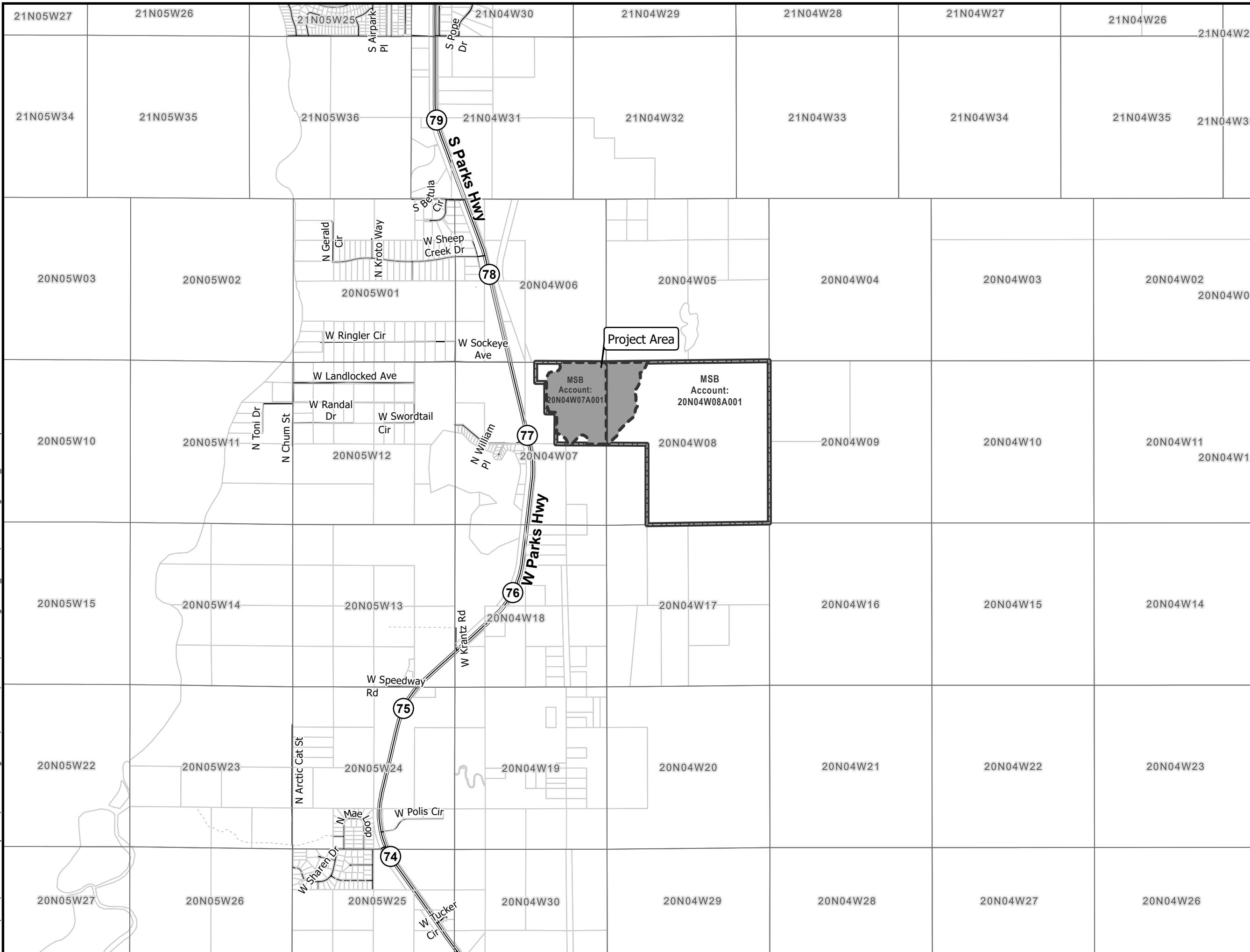

Path: P:\User\Comm Development\Land Management\Resources\Gravel\LandManagement_Gravel.aprx