

**SUBJECT: ASSEMBLY NOTIFICATION OF LAND ACQUISITION OF ONE ACRE
ADJACENT TO THE NEW GATEWAY VISITOR CENTER. (MSB007999)**

AGENDA OF: August 19, 2025

ASSEMBLY ACTION:

AGENDA ACTION REQUESTED: For information only.

Route To	Signatures
Originator	<div>7 / 3 1 / 2 0 2 5</div> <div>X L i s a G r a y</div> <div>S i g n e d b y : L i s a G r a y</div>
Land & Resource Management Manager	<div>7 / 3 1 / 2 0 2 5</div> <div>X J o e M e t z g e r</div> <div>S i g n e d b y : J o e M e t z g e r</div>
Community Development Department Director	<div>8 / 1 / 2 0 2 5</div> <div>X J i l l i a n M o r r i s s e y</div> <div>S i g n e d b y : J i l l i a n M o r r i s s e y</div>
Finance Director	<div>8 / 1 / 2 0 2 5</div> <div>X L i e s e l Z a n t o f o r C H</div> <div>S i g n e d b y : L i e s e l W e i l a n d</div>
Borough Attorney	<div>8 / 4 / 2 0 2 5</div> <div>X J o h n A s c h e n b r e n n e r</div> <div>S i g n e d b y : J o h n A s c h e n b r e n n e r</div>
Borough Manager	<div>8 / 4 / 2 0 2 5</div> <div>X M i c h a e l B r o w n</div> <div>S i g n e d b y : M i k e B r o w n</div>
Borough Clerk	<div>8 / 7 / 2 0 2 5</div> <div>X E s t e l l e W i e s e f o r</div> <div>S i g n e d b y : E s t e l l e W i e s e</div>

ATTACHMENT (S) : Map and Drawing (2 pp)

SUMMARY STATEMENT:

The Community Development Department proposes purchasing a one-acre lot next to the new Gateway Visitor Center known as 8798 E. Tex Cobb Circle, tax account number 17N01E23B002. This property is privately owned, and the land is vacant. If a structure was ever constructed on said property it could block a portion of the mountain views to the east from the visitor center. Attached is a map showing the location of the property and a drawing that shows

the Gateway Visitor Center with topographic contour lines.

Land & Resource Management proposes using the Land Management Permanent Funds for land acquisition.

MATANUSKA-SUSITNA BOROUGH

FISCAL NOTE

Agenda Date: August 19, 2025

SUBJECT: **ASSEMBLY NOTIFICATION OF LAND ACQUISITION OF ONE ACRE ADJACENT TO THE
NEW GATEWAY VISITOR CENTER. (MSB007999)**

FISCAL ACTION (TO BE COMPLETED BY FINANCE)	FISCAL IMPACT YES NO
AMOUNT REQUESTED *	FUNDING SOURCE Land Management Perm. Fund
FROM ACCOUNT # 203.000.000 4xx.xxx	PROJECT
TO ACCOUNT:	PROJECT #
VERIFIED BY: <div style="text-align: right;">8 / 1 / 2 0 2 5</div> <div style="text-align: center;"> <input checked="" type="checkbox"/> M e r i s s a C a r r e l l </div> <div style="text-align: center;">Signed by: M e r i s s a C a r r e l l</div>	

EXPENDITURES/REVENUES:

(Thousands of Dollars)

OPERATING	FY2025	FY2026	FY2027	FY2028	FY2029	FY2030
Personnel Services						
Travel						
Contractual						
Supplies						
Equipment						
Land/Structures		*				
Grants, Claims						
Miscellaneous						
TOTAL OPERATING		*				

CAPITAL						
---------	--	--	--	--	--	--

REVENUE						
---------	--	--	--	--	--	--

FUNDING:

(Thousands of Dollars)

General Fund						
State/Federal Funds						
Other		*				
TOTAL		*				

POSITIONS:

Full-Time						
Part-Time						
Temporary						

ANALYSIS: (Attach a separate page if necessary) *Amount depends on price negotiation with owner for the sale.

APPROVED BY:	8 / 1 / 2 0 2 5
	<div style="text-align: center;"> <input checked="" type="checkbox"/> L i e s e l Z a n t o </div> <div style="text-align: center;">Signed by: L i e s e l W e i l a n d</div>

IM 25-170

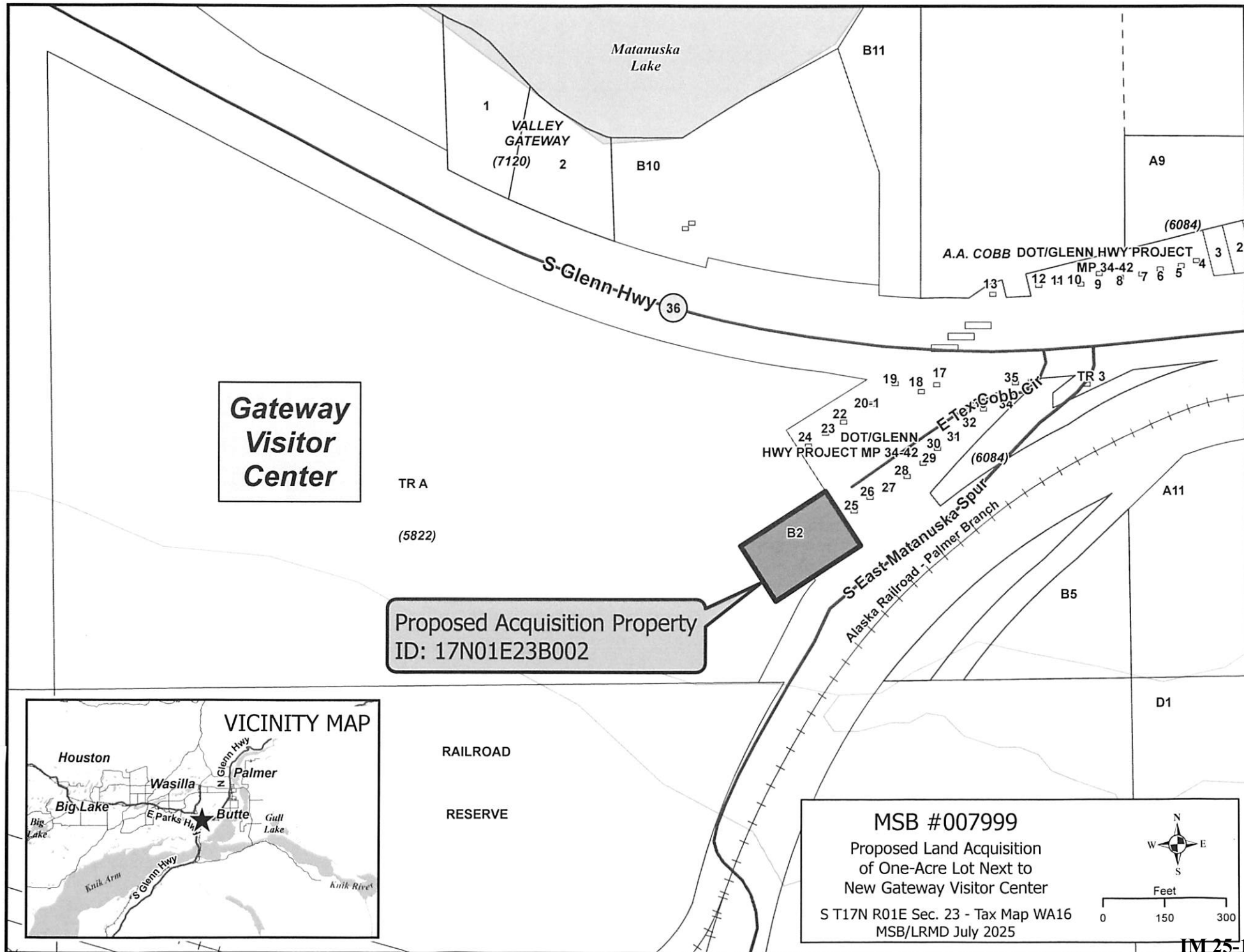

MSB #007999
Proposed Land Acquisition
of One-Acre Lot Next to
New Gateway Visitor Center
S T17N R01E Sec. 23 - Tax Map WA16
MSB/LRMD July 2025

Feet
0 150 300

N
W E
S

IM 25-170

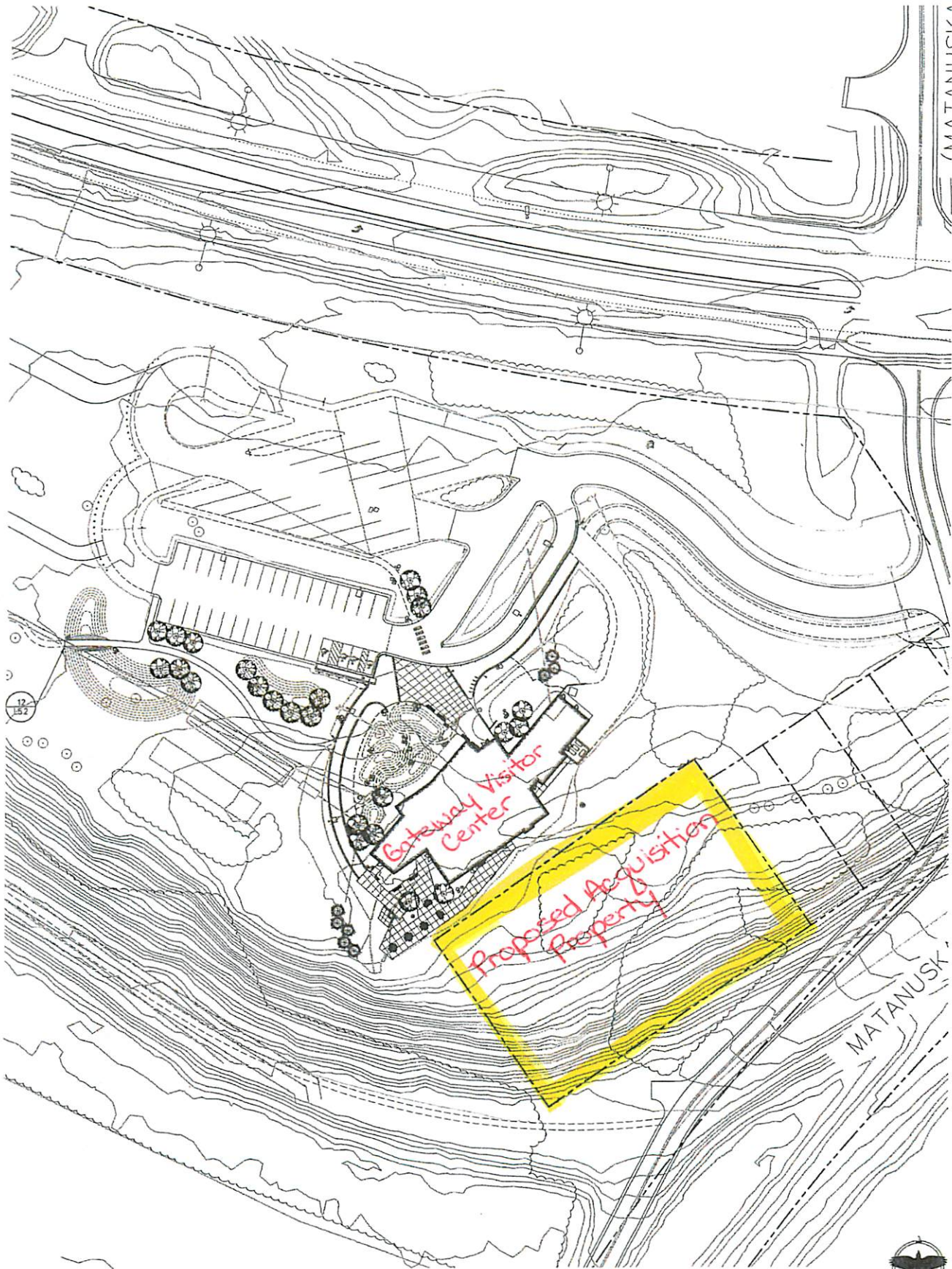

0' 40' 80' 120'

